

A record of a Survey made on Section five in the Town of Turtle
Town one Range thirteen

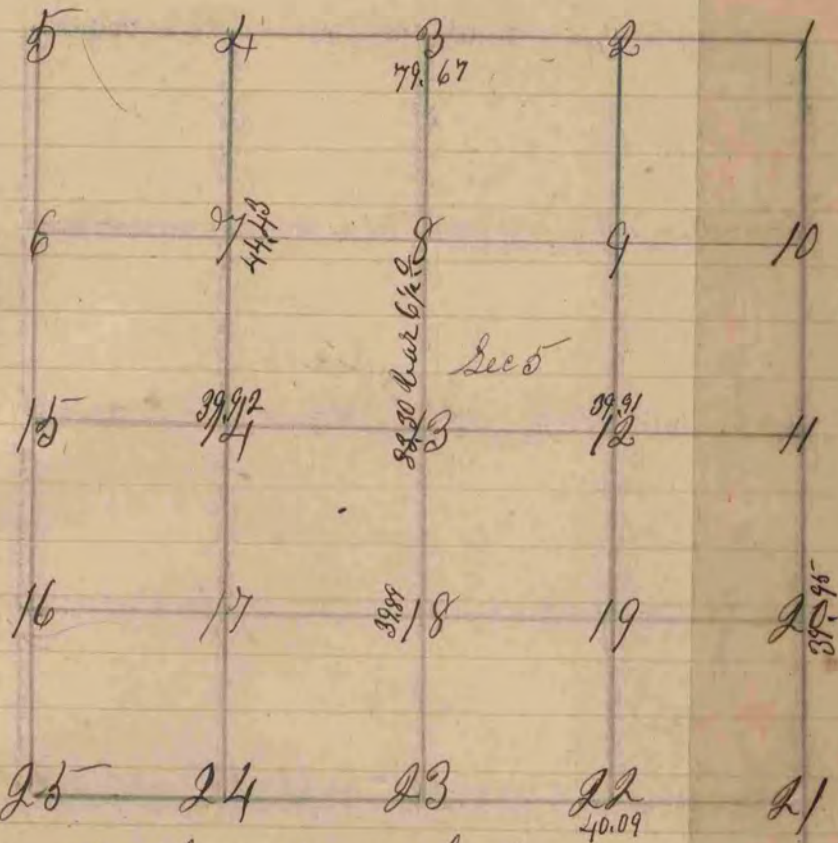

figure 13 represents the centre of the section

fig 13 buried a stone 15 inches long 10 wide 5 thick even with
the surface of the ground

fig 12 buried a stone 18 inches in sod fence

The above survey was made May 16th 1853

Peter M. Bean County Surveyor