

surrounded by with glau-
sious and rock bearing stones
lime stone S 24° 45' E 54 1/2
" " N 7° 27' W 50

surrounded part with 3 lime stones
and rock bearing stones
lime stone S 24° 45' E 54 1/2
" " N 7° 27' W 50

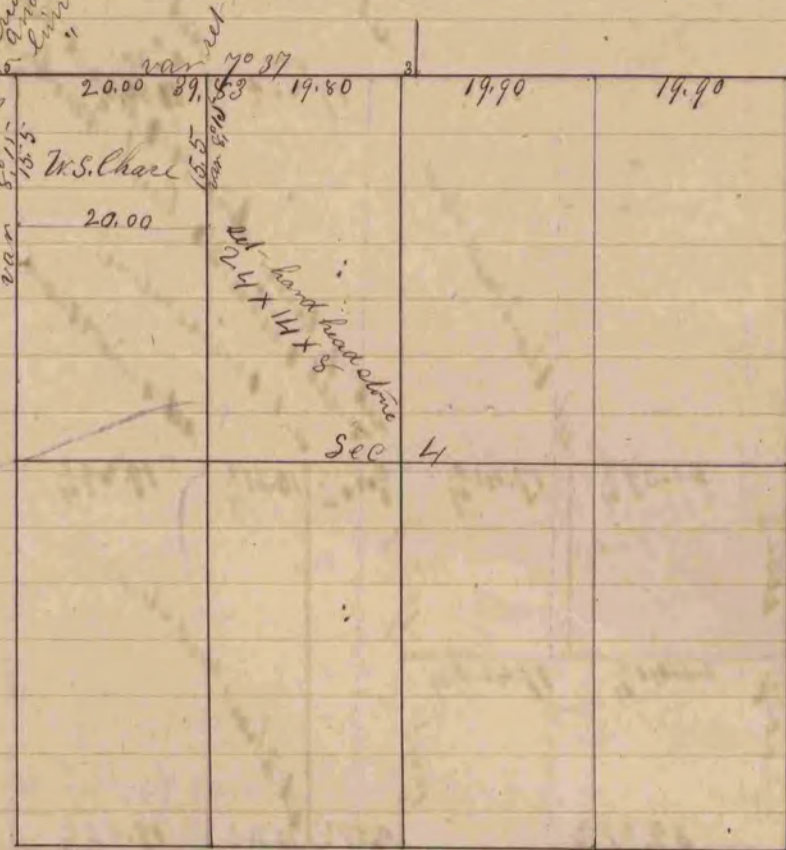

The above is a record and plat of a survey made on
 section 4 Town 2 North Range 12 East
 Rock by Edward Rager County Surveyor
 for Rock County Wis