

A Record & Plat of a Survey on Sec. 30 T. 2, R. 12 E

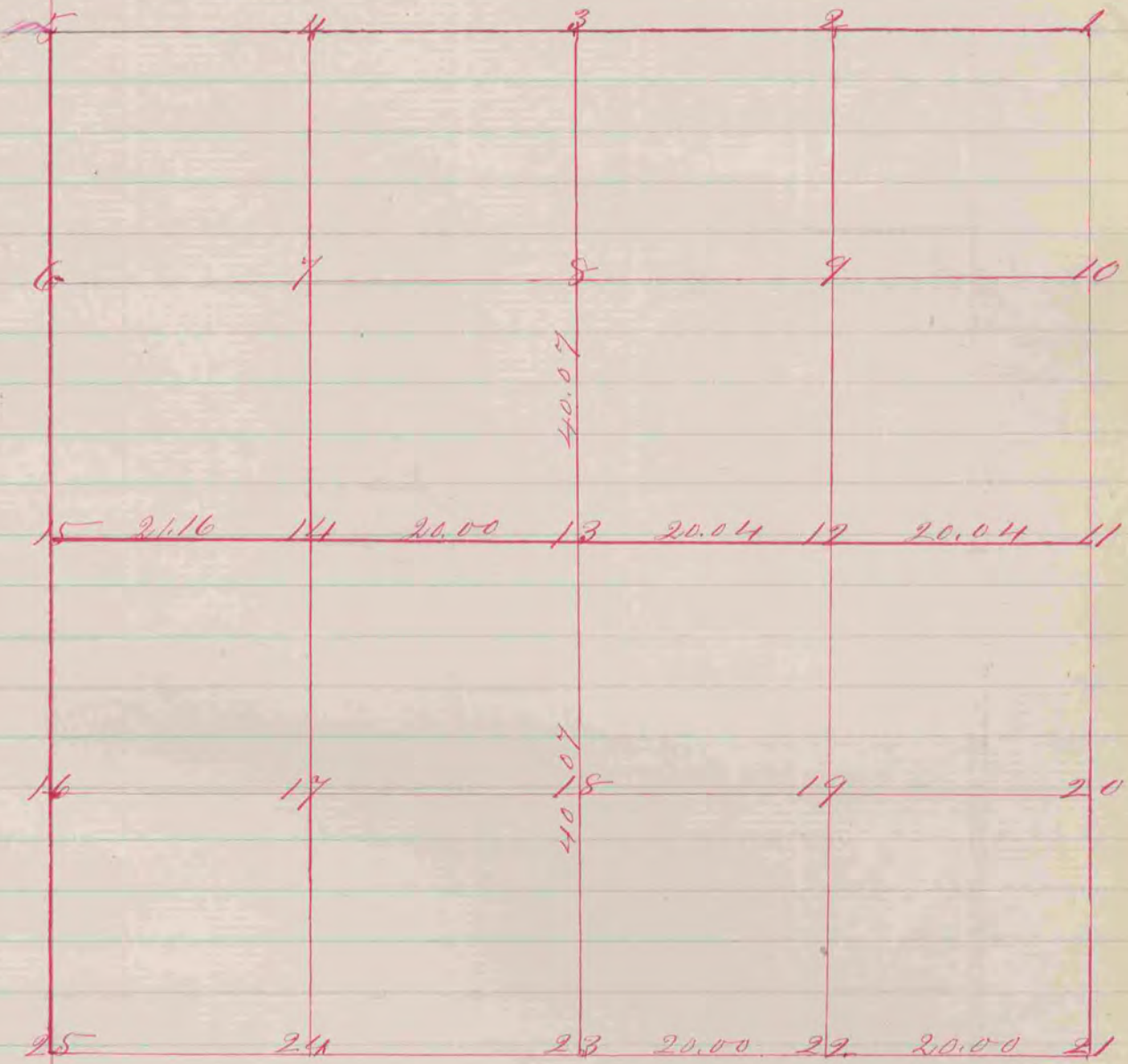

Fig 13 W.O. 12 N. 35 1/4 W 85 lks.  
 " 12 Bl. " N 55 E 76 "  
 " 14 Bar. " N 10 1/2 E 106 "  
 " W.O. S 8 1/2 W 144 "  
 22 W.O. S 55 E 113 "  
 " Bl.O. S 66 W 190 "

The above Survey was made April 6, 1858  
 Joseph Church Co. Surveyor

(Recorded in Vol I page 31)