

COUNTY SURVEYOR
RECORD 1859-1906

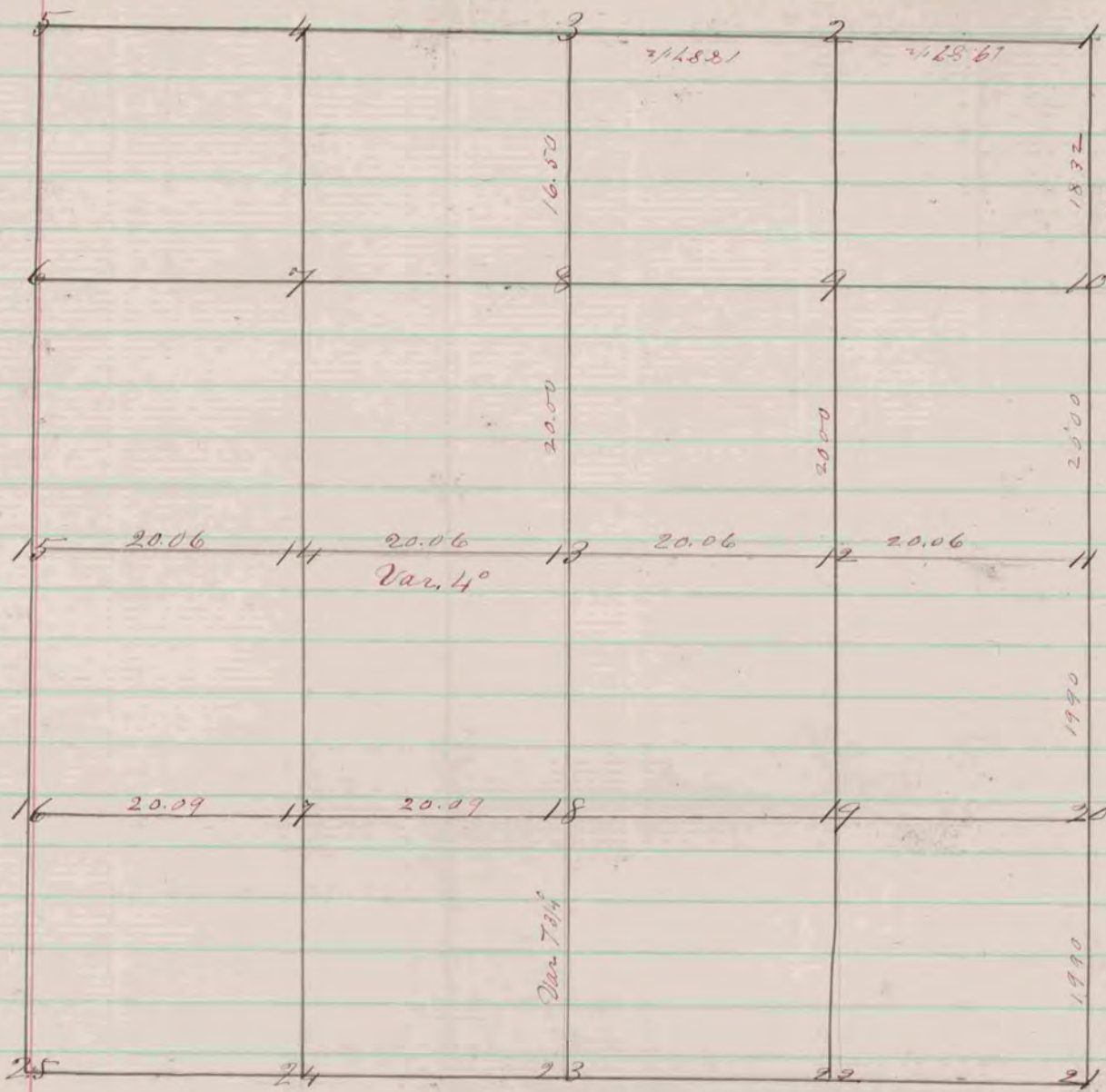

- Fig 13 Br. @ 14 S 29 1/2 E 128 Br. @ 12 N 60 E 135.
- 12 " 18 N 1 1/2 E 201 " " S 82 W 141
- 18 Bl. @ 14 N. 45 3/4 E 14
- 16 Br. @ 12 N 14 1/2 E 222 Br. @ 14 N 64 E 43
- 2 Post & Stone
- 3 " "
- 8 " "
- 10 " "

A Record & Plat of a Survey made on Sec. 153
R 10 E. Magnolia - Aug. 1853
Joseph Church
Co. Surveyor

COUNTY SURVEYOR
RECORD 1859-1906