

See page 403.

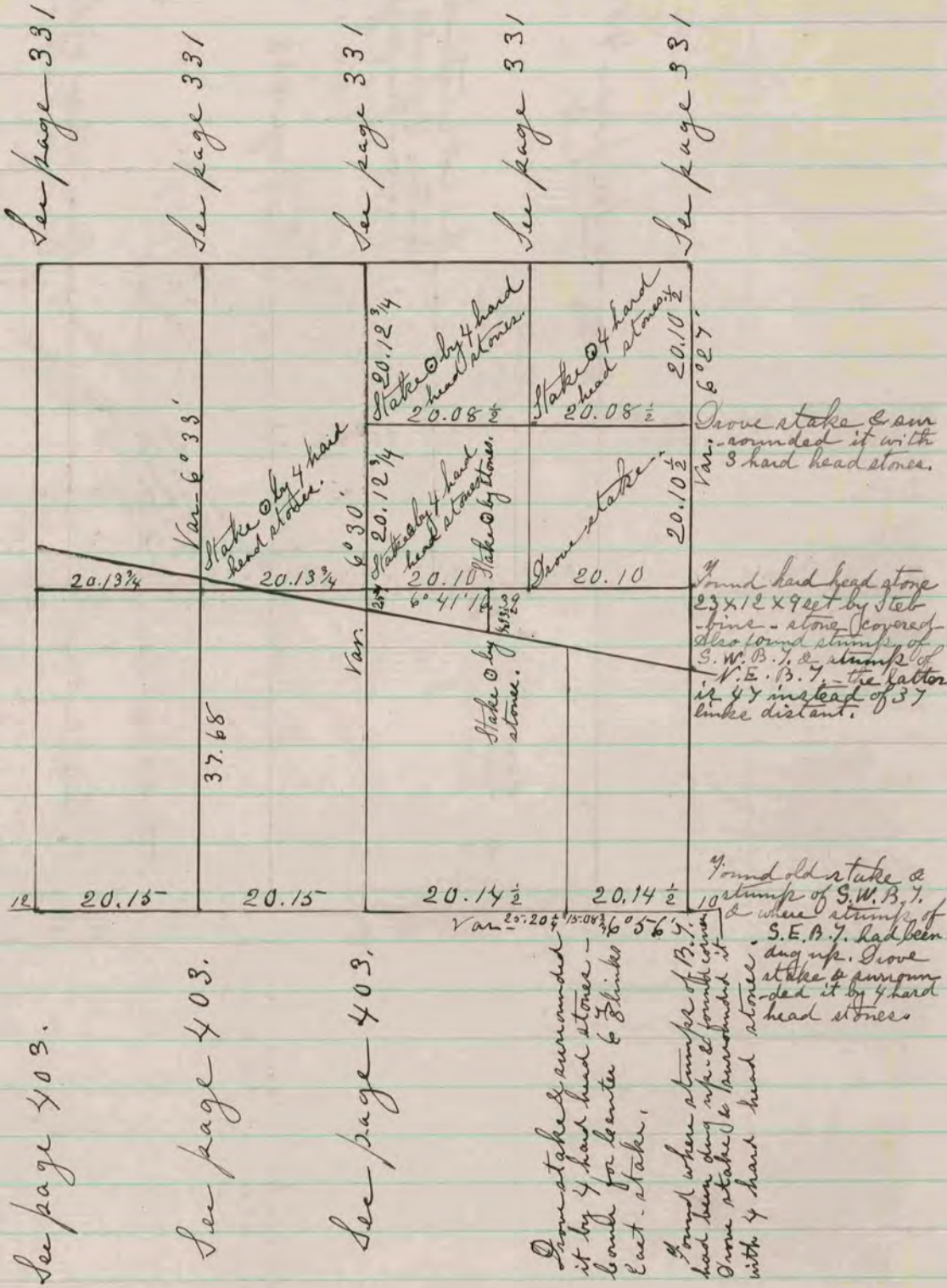

See page 403.

See page 403.

See page 403.

Some stakes surrounded it by 4 hard head stones - look for lumber & blinks East stake.

Found where stump of B. 7. had been dug up & surrounded it with 4 hard head stones. Some stake & surrounded it with 4 hard head stones.

The above is a record & plat of a Survey made by me on Section 32 - Porter - April 9 & 10 1875.

Edward Ringer
County Surveyor.

COUNTY SURVEYOR
RECORD 1859-1900