

See section 11. Page 443-

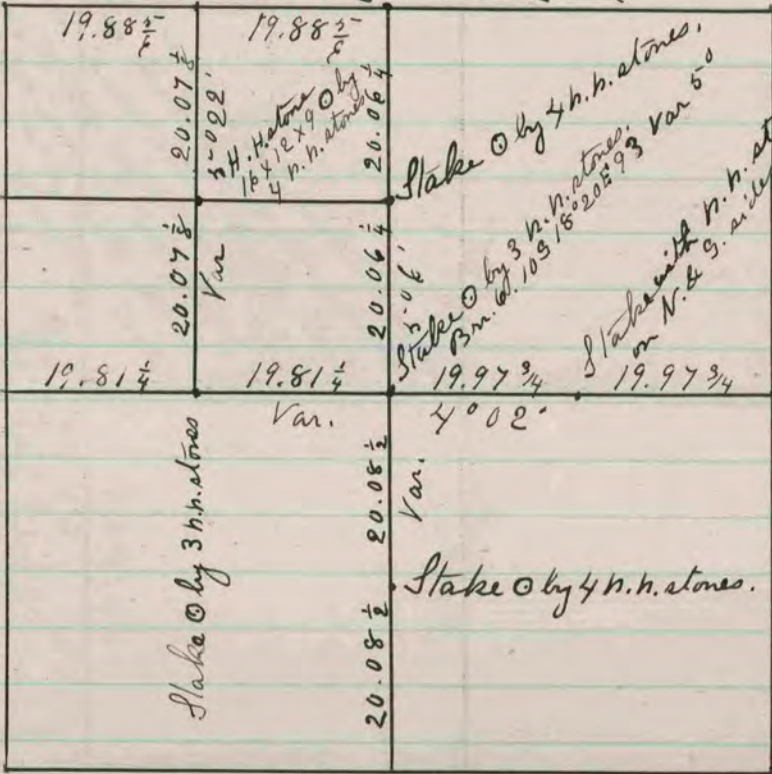

Found old stake & N.E. when stump of both B. 7. had been dug up. Set hard head stone 16 x 12 x 7 point up & surrounded it by 4 lime stones & took B. 7. W. 0. 12 N 8° E 43 3/4 W. 0 10 N 15° W 47.

Found old stake & N.E. B. 7. when stump of S. F. B. 7. had been dug up. Set hard head stone 13 x 8 x 6 & surrounded it by 4 h. h. stones - took B. 7. B. 7. 0. 8 N. 49 1/2 E 6 B. 7. 0 10 N 41° W 5 1/3

Found large stake at corner also found remains of stump of B. 7. Planted large flat lime stone to preserve the location of the bearing tree - took new bearing tree - B. 7. 0. 13. N 52° W 1130 3/4 Var. 5° surrounded corner with 5 h. h. stones. Distance to old B. 7. 115-9 instead of 1172.

The above is a record and plat of a Survey made by me on Section 12 Limal June 13 & 14 - 1876

Edward Ruger
County Surveyor