

Found Monument  
N.W. Cor  
Sec. 30.

MILTON AVENUE

24.19 1/2 recorded dis. from 1/4 cor. to E. line of N. 10c  
24.24 my measurement  
4 1/2 links excess  
9.72 recorded dis. or lengths of lot 1 on N. side  
add. 0.19 = proportional excess  
9.739

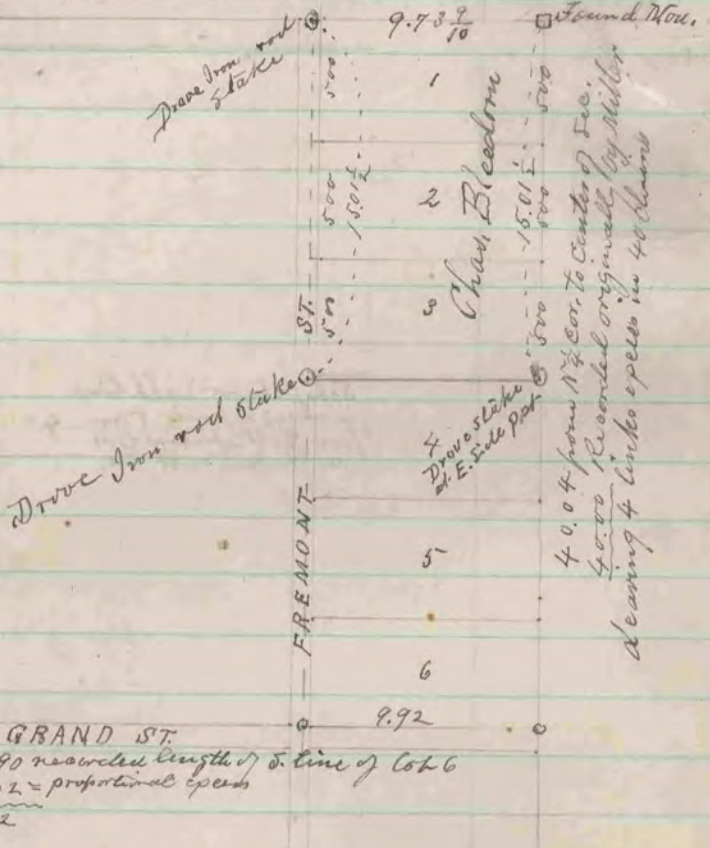

GRAND ST.  
9.90 recorded length of S. line of Lot 6  
Add .02 = proportional excess  
9.92

The above is a record and plat of a survey made by me on Section 30, Harmony, in S.D. Smith's Addition to Jamesville for the purpose of determining the boundaries of Lots 1, 2, 3, 4, 5, 6 in said Addition, and was made May 26<sup>th</sup> & 27<sup>th</sup> 1881.

Center of Sec. Found a stake and red brick

R. K. Lee  
Co. Surveyor.