

The above is a plat and record of a survey made by me May 7 & 8, 1890. on Section 5 T2 R9 E of Hedora

Deft. Co. Surveyor

Set Large hhd point up @ 3 hhd Found corner set by Reger

SW 1/4 sec

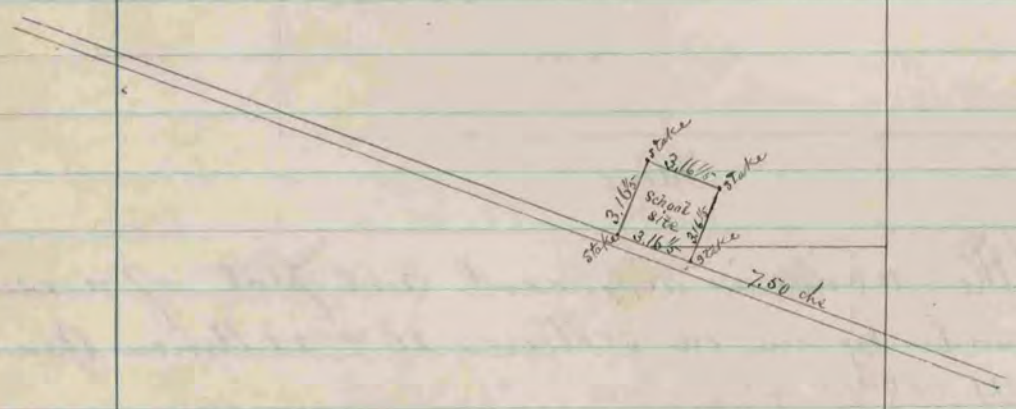

The above is a plat & record of a survey made by me on Sec. 13 Spring Valley May 13/90

O. H. Hedora
Deft Co Surveyor