

PLAT AND RECORD

Of a Survey on Section 33 T 4 R 13 E. of the 4 P. M. in Milton Township

Rock County, Wisconsin, made June the 20+21 1864

I hereby certify that the following is a correct record of said survey as made by me.

COUNTY BUILDING
IN CITY OF BELOIT

(Signed) J. P. Locke
JPL

County Surveyor.

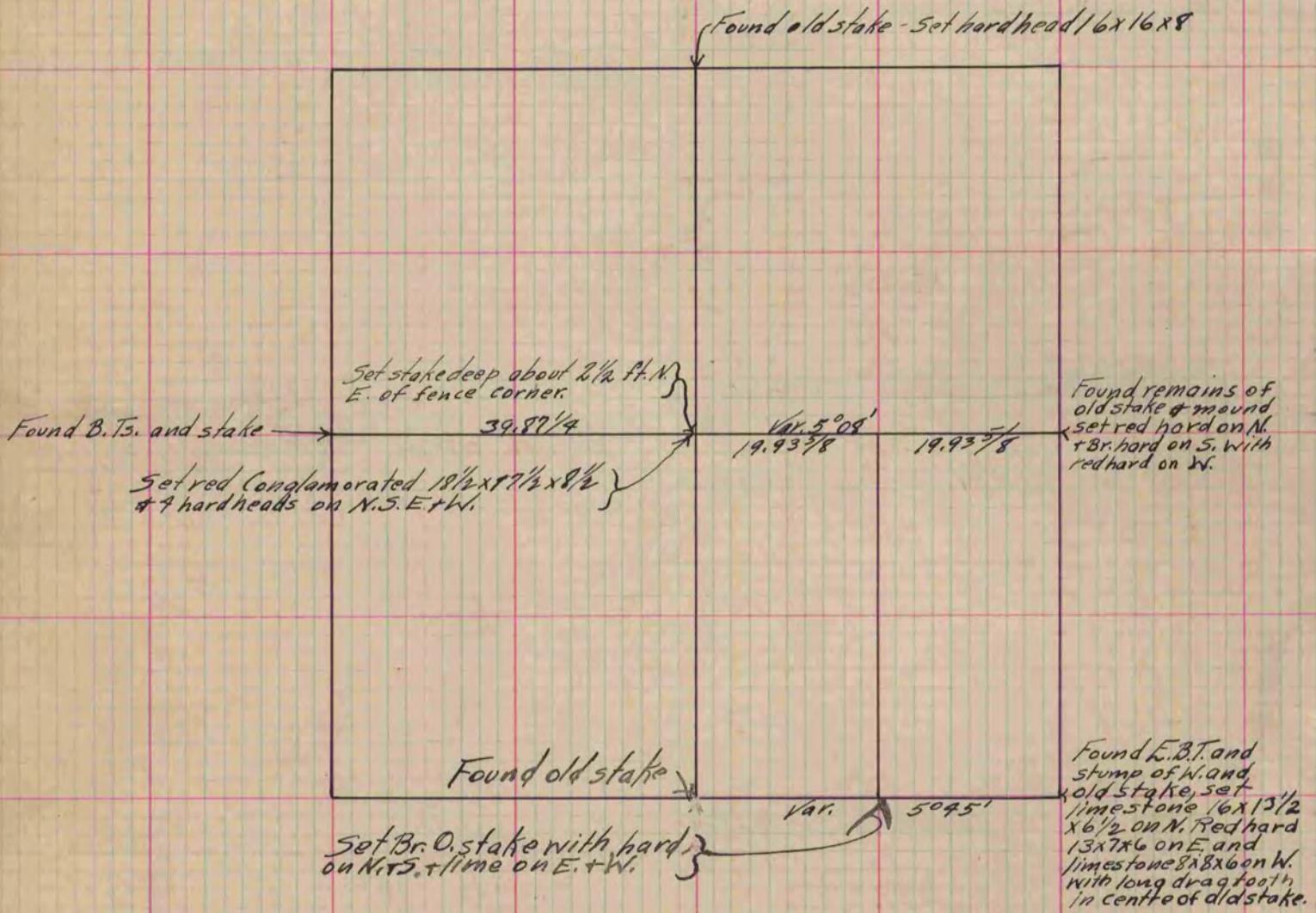

Copied from Page 207 Vol. 1 Original County Surveyors Record.