

PLAT AND RECORD

Of a Survey on Section 28 T 1 R 10 E. of the 4 P. M. in Avon Township

Rock County, Wisconsin, made December the 6 1864

I hereby certify that the following is a correct record of said survey as made by me.

COUNTY BUILDING
IN CITY OF BELOIT

(Signed) S. D. Loche
RMB

County Surveyor.

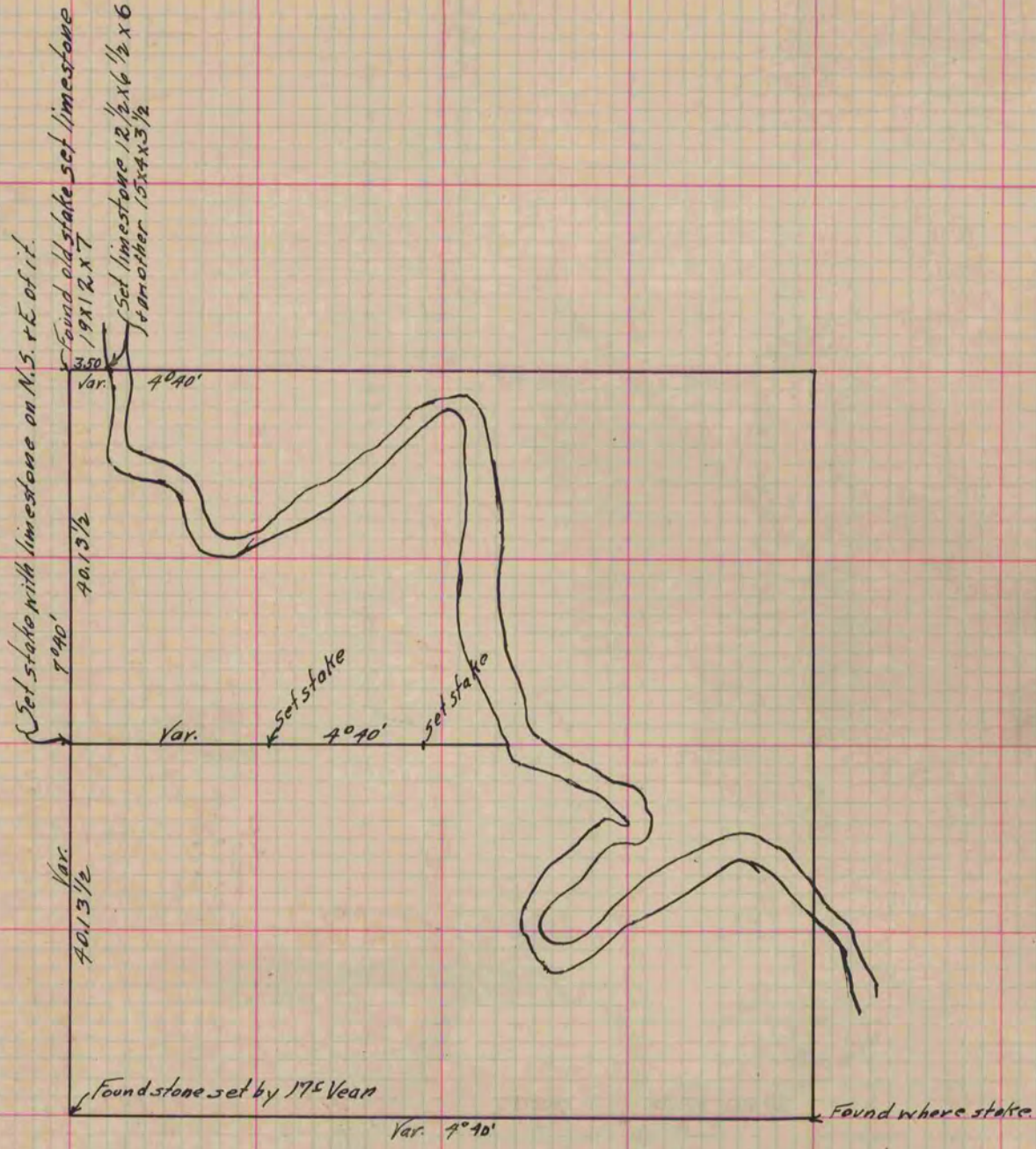

Copied from upper 1/2 of Page 213 Vol. 1 Original County Surveyor's Record.