

# PLAT AND RECORD

249

Of a Survey on Section 4 T 3 R 13 E. of the 4 P. M. in Harmony Township  
Rock County, Wisconsin, made April the 1866

I hereby certify that the following is a correct record of said survey as made by me.

(Signed) S. D. Locke  
S. D. Locke

County Surveyor.

COUNTY BUILDING  
IN CITY OF BELOIT

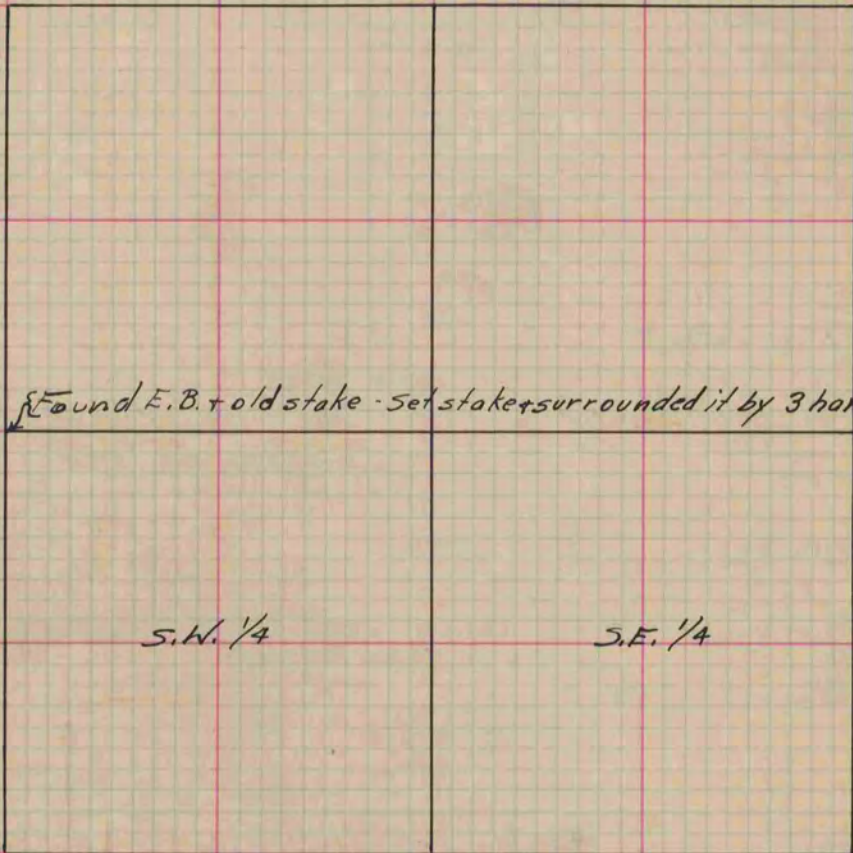

Copied from Page 226 Vol. 1. Original County Surveyor's Record.