

# PLAT AND RECORD

Of a Survey on Section 5 T 1 R 14 E. of the 4 P. M. in Clinton Township

Rock County, Wisconsin, made June the 14 1878

I hereby certify that the following is a correct record of said survey as made by me.

COUNTY BUILDING  
IN CITY OF BELOIT

(Signed) *Edward Ruger*  
*A.M.S.*

County Surveyor.

*Found Cor. est. by self in former survey*

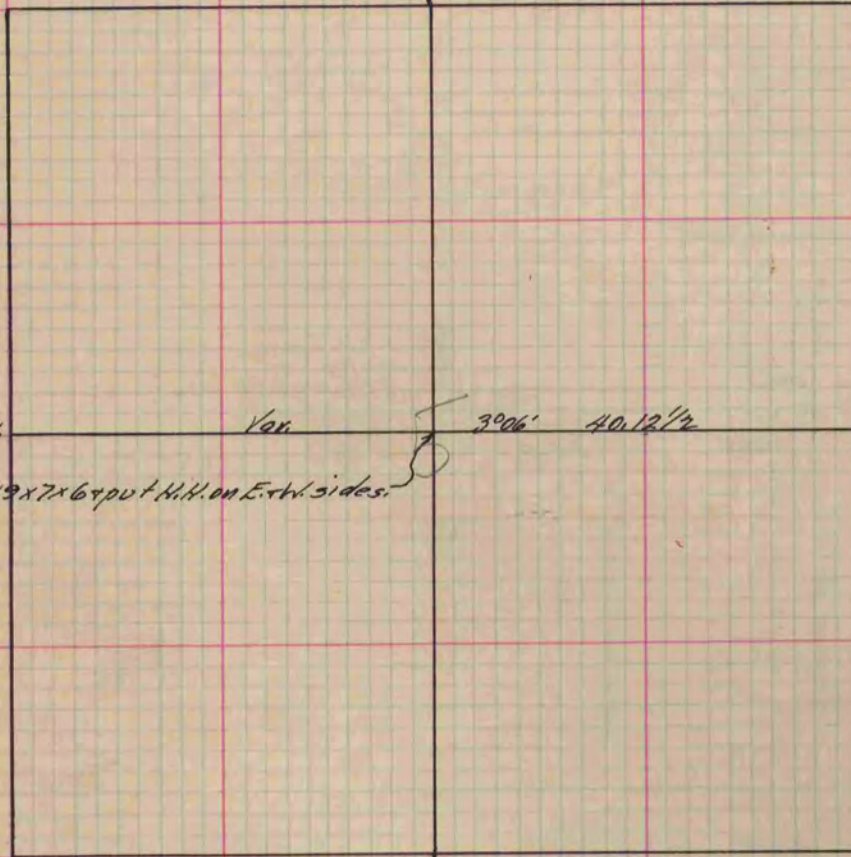

*Found old stake set limestone 24x8x8 & 0 ft by a lot of small stones.*

*Found where Cor. stone had been removed to set fence post. set H.H. 18x9x9x0 ft by A.M.S.*

*set limestone 19x7x6 & put H.H. on E. & W. sides.*

*Found Cor. est. by self in a Survey of Sec. 8 Clinton*

*Copied from P. 212 Vol. 2 County Surveyors Record.*