

PLAT AND RECORD

Of a Survey on Section 11 T 2 R 12 E. of the 4 P. M. in Rock Township

Rock County, Wisconsin, made April the 20th 1880

I hereby certify that the following is a correct record of said survey as made by me.

COUNTY BUILDING
IN CITY OF БЕЛОIT

(Signed) R. K. Lee
RKL:R

Dept. County Surveyor.

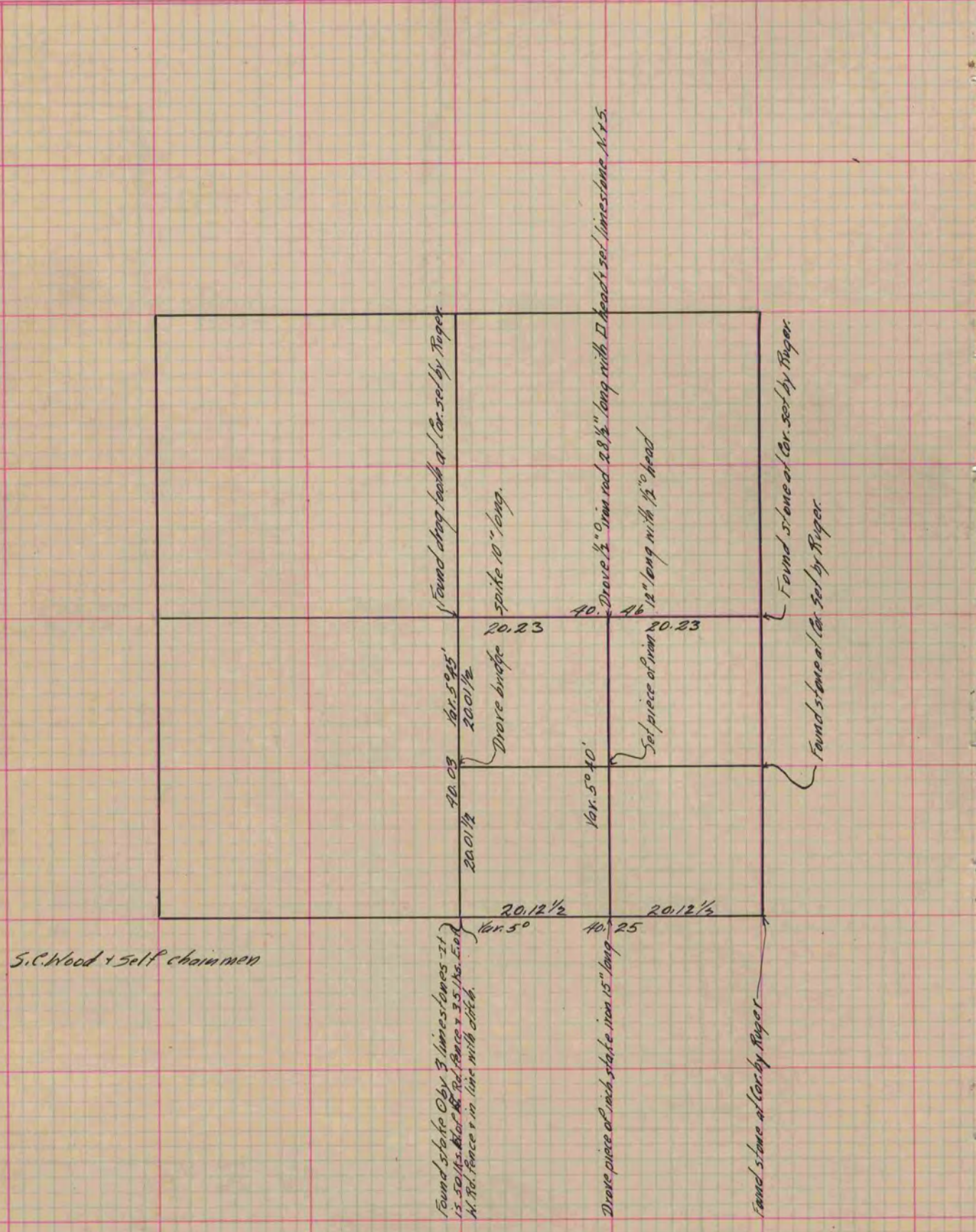

Copied from P. 250 Vol. 2 County Surveyor's Record.