

PLAT AND RECORD

413

Of a Survey on ^{S.E. 1/4} Section 27 T 2 R 12 E. of the 4 P. M. in Rock Township

Rock County, Wisconsin, made Nov. the 21 1887

I hereby certify that the following is a correct record of said survey as made by me.

COUNTY BUILDING
IN CITY OF БЕЛОIT

(Signed) Edward Ruger
E.M.B.

County Surveyor.

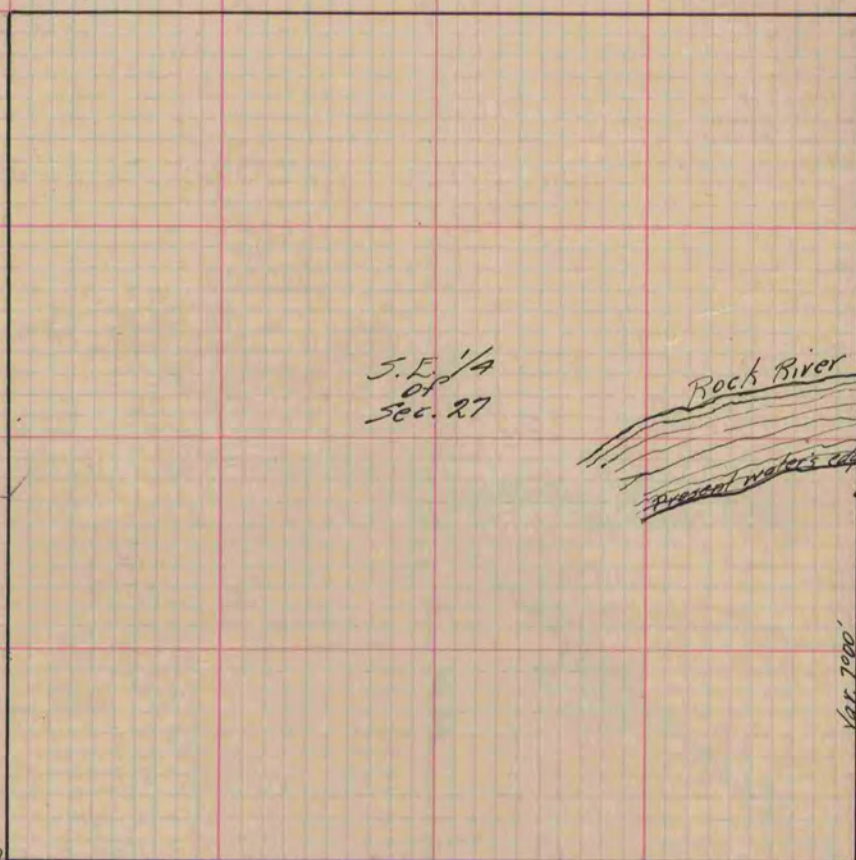

Meander Cor. Found remains of old stake
& stump of S.E. B.T. where stump of S.W.
B.T. had been dug up. Put new
stake in place of old.

Var. 7000'
17.87 1/2

Found stake Obv.
2 N. 45. 4 1/2 lime stakes

Found remains of old stake S.E.
B.T. & stump of N.E. B.T. - Cor. is 9"
N. of Cor. fence post.

Copied From P. 334 Vol. 2 County Surveyor's Record.