

# PLAT AND RECORD

Of a Survey on Section 13 T 2 R 10 E. of the 4 P. M. in Spring Valley Township  
Rock County, Wisconsin, made May the 13<sup>th</sup> 1890

I hereby certify that the following is a correct record of said survey as made by me.

COUNTY BUILDING  
IN CITY OF BELOIT

(Signed) O.G. Bleedorn  
WMB Dep. County Surveyor.

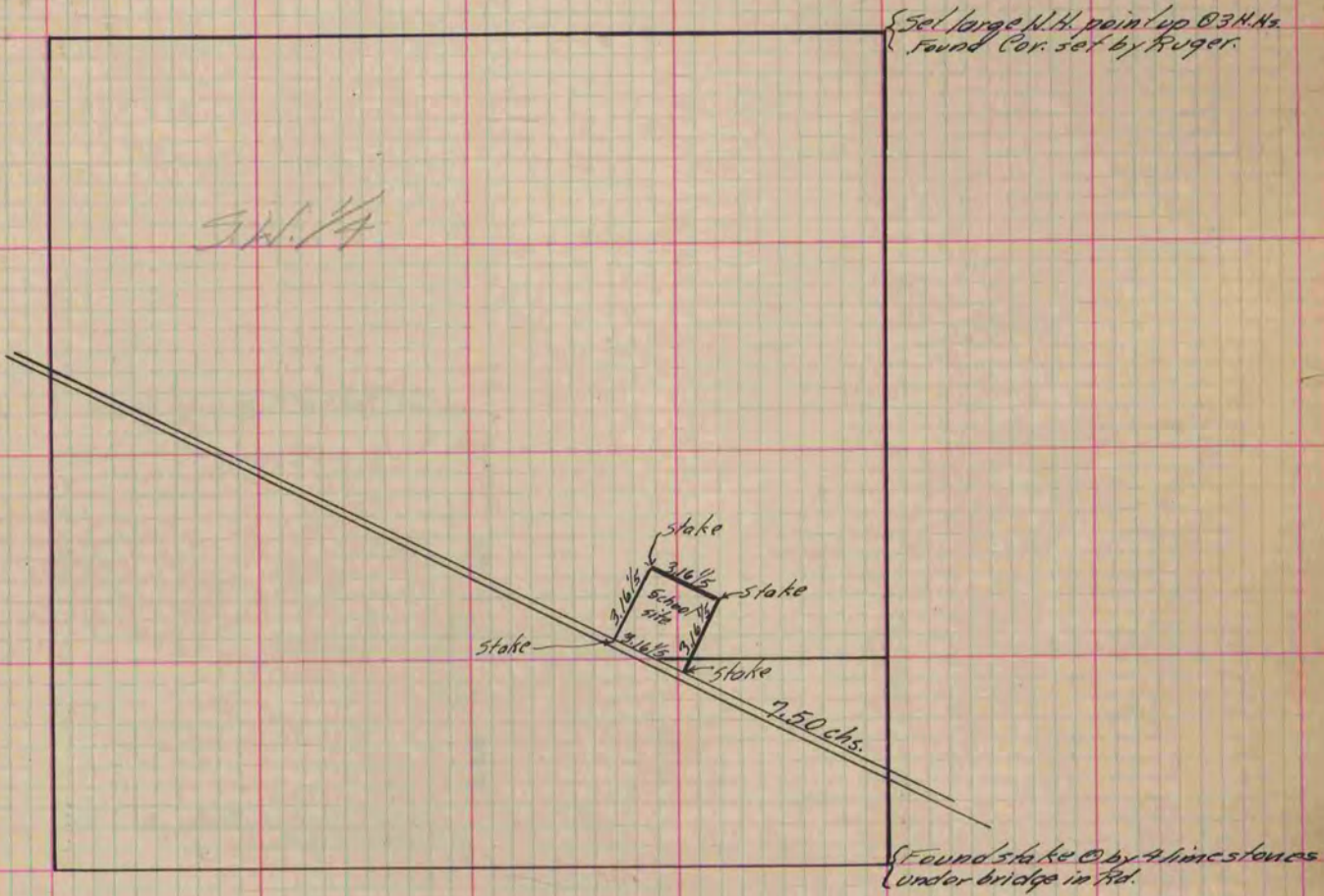

Copied From P. 348 Vol. 2 County Surveyor's Record.