

# PLAT AND RECORD

Of a Survey on Section 2A T A R 12 E. of the 4 P. M. in Fulton Township  
Rock County, Wisconsin, made the \_\_\_\_\_ 19\_\_\_\_

I hereby certify that the following is a correct record of said survey as made by me.

COUNTY BUILDING  
IN CITY OF BELOIT

(Signed) P.F. BROWN  
P.F.B.

County Surveyor.

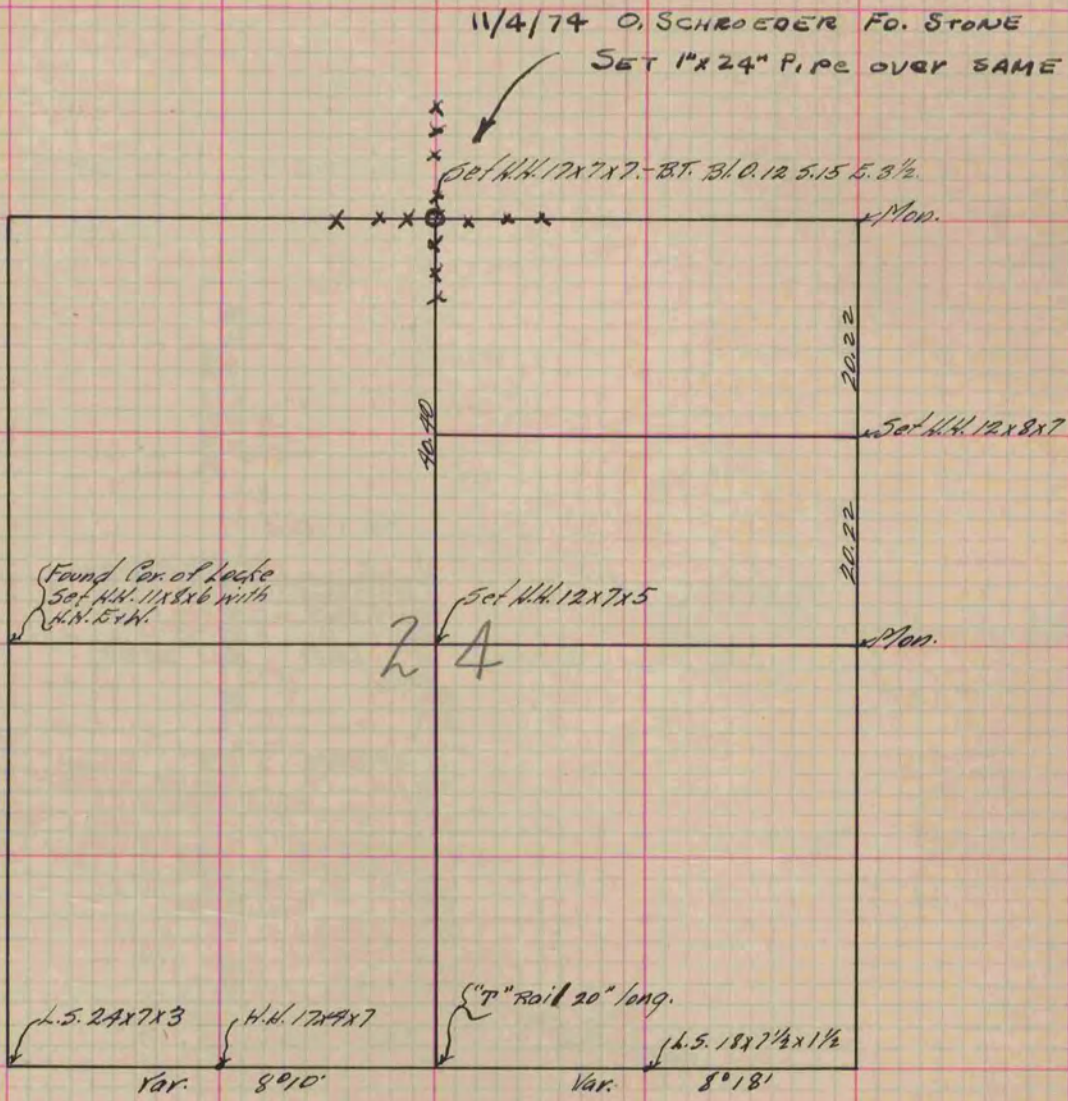

Copied from P. 382 Vol. 2 County Surveyor's Record.