

PLAT AND RECORD

Of a Survey on Section 17 T. 4 N. R. 13 E. of the 4 P. M. in MILTON Township

Rock County, Wisconsin, made MAY the 1 1970

I hereby certify that the following is a correct record of said survey as made by me.

COUNTY BUILDING
IN CITY OF BELOIT

Robert H. ...

County Surveyor.

5/1/70
B.T.
T.N.

N. 1/4 COR. OF SEC. 17-4-13
FD. 6x6 CUTSTONE. SET
MON BOX & 1" PIPE

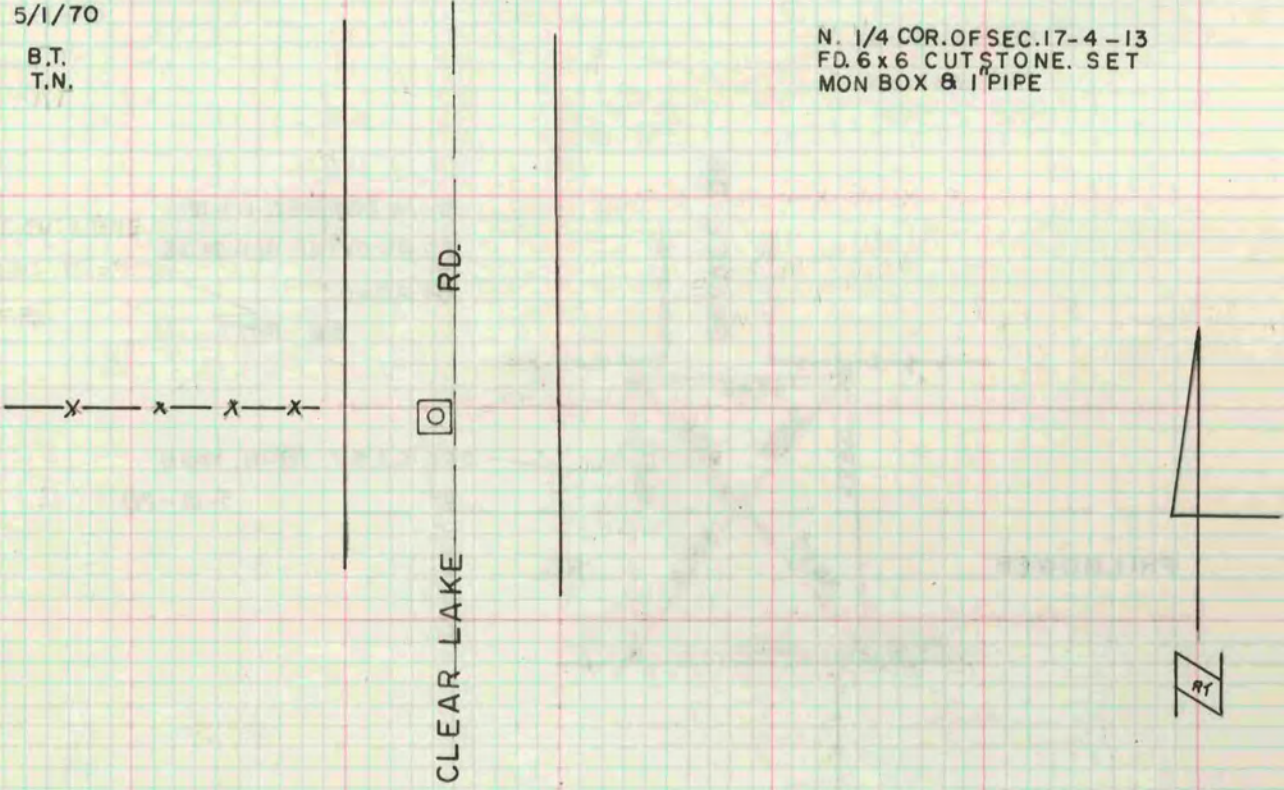

5/1/70
B.T.
T.N.

FD. 2" PIPE SURROUNDED
BY 4 H. H S. 1/4 COR. SEC 17-4-13

