

PLAT AND RECORD

Of a Survey on Section 16 T 3 N R 12 E. of the 4 P. M. in JANESVILLE Township

Rock County, Wisconsin, made APRIL the 8 1970

I hereby certify that the following is a correct record of said survey as made by me.

COUNTY BUILDING
IN CITY OF БЕЛОIT

R. B. Egan

County Surveyor.

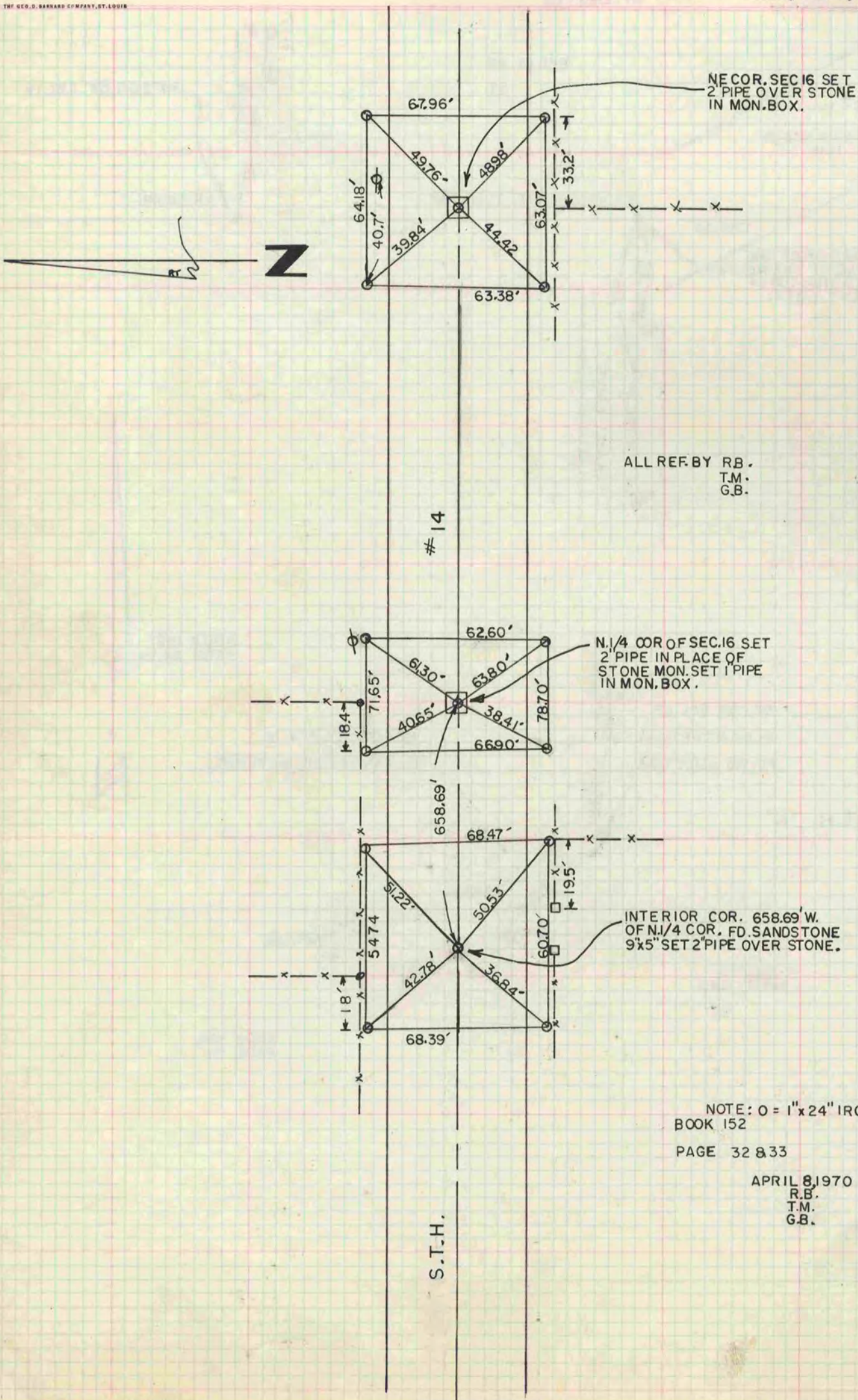

ALL REF. BY R.B.
T.M.
G.B.

N. 1/4 COR. OF SEC. 16 SET
2" PIPE IN PLACE OF
STONE MON. SET 1" PIPE
IN MON. BOX.

INTERIOR COR. 658.69' W.
OF N. 1/4 COR. FD. SANDSTONE
9"x5" SET 2" PIPE OVER STONE.

NOTE: O = 1" x 24" IRON PIPE
BOOK 152

PAGE 32 & 33

APRIL 8, 1970
R.B.
T.M.
G.B.