

V-2 MICROFILMED PLAT AND RECORD

Of a Survey on Section 13 1/2 T 4 R 8 1/2 E. of the 4 P. M. in Exeter + Brooklyn Township
Green County, Wisconsin, made September the 9 1876

I hereby certify that the following is a correct record of said survey as made by me.

COUNTY BUILDING
CITY OF JANESVILLE

(Signed) Edward Ruger
R.H.B. County Surveyor.

Found stumps of both B.T.s. The Cor. as found from the B.T.s. stumps is in line with fence running N. 4 in line with fence running S. on Town Line. It is about 4 in N. of the N. fence part of the fence running S. There are 2 trees left standing near the line between Secs 13 & 14 which had evidently been blazed in the U.S. Survey

Found remains of old stake & where stumps of both B.T.s. had been dug up. The stump remains at the right distance & in the right direction from the corner. The Cor. is 1.35 1/2 chs. N. of the Exeter Cor. instead of 100 S. as given in the U.S. Survey notes. The Cor. is in line with the fence running E & X with the fence running N.

Exeter
T. 4 R. 8
Sec. 13
Sec. 18
T. 4 R. 9
Brooklyn.

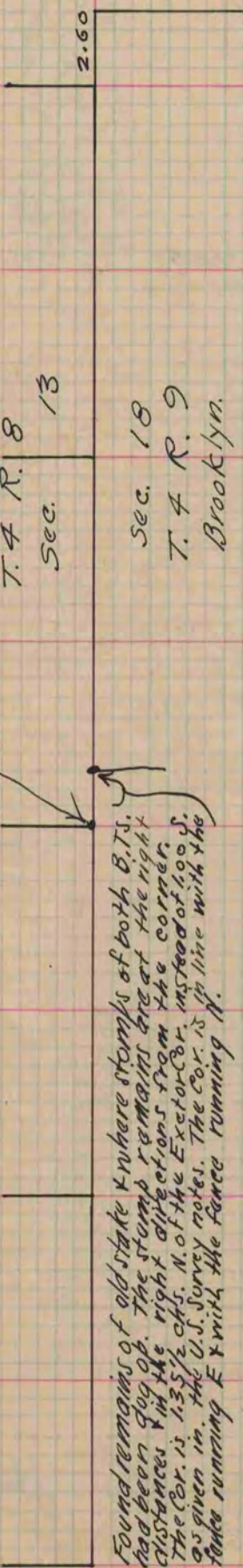

Copied from page 190 Vol. 2 County Surveys Record