

MICROFILMED

PLAT AND RECORD

299
V-2

COUNTY BUILDING
CITY OF JANESVILLE

Of a Survey on Section 10 T 1 R 14 E. of the 4 P. M. in Clinton Township

Rock County, Wisconsin, made May the 3 1880

I hereby certify that the following is a correct record of said survey as made by me.

(Signed) R.K. Lee
R.H.B. Dep. County Surveyor.

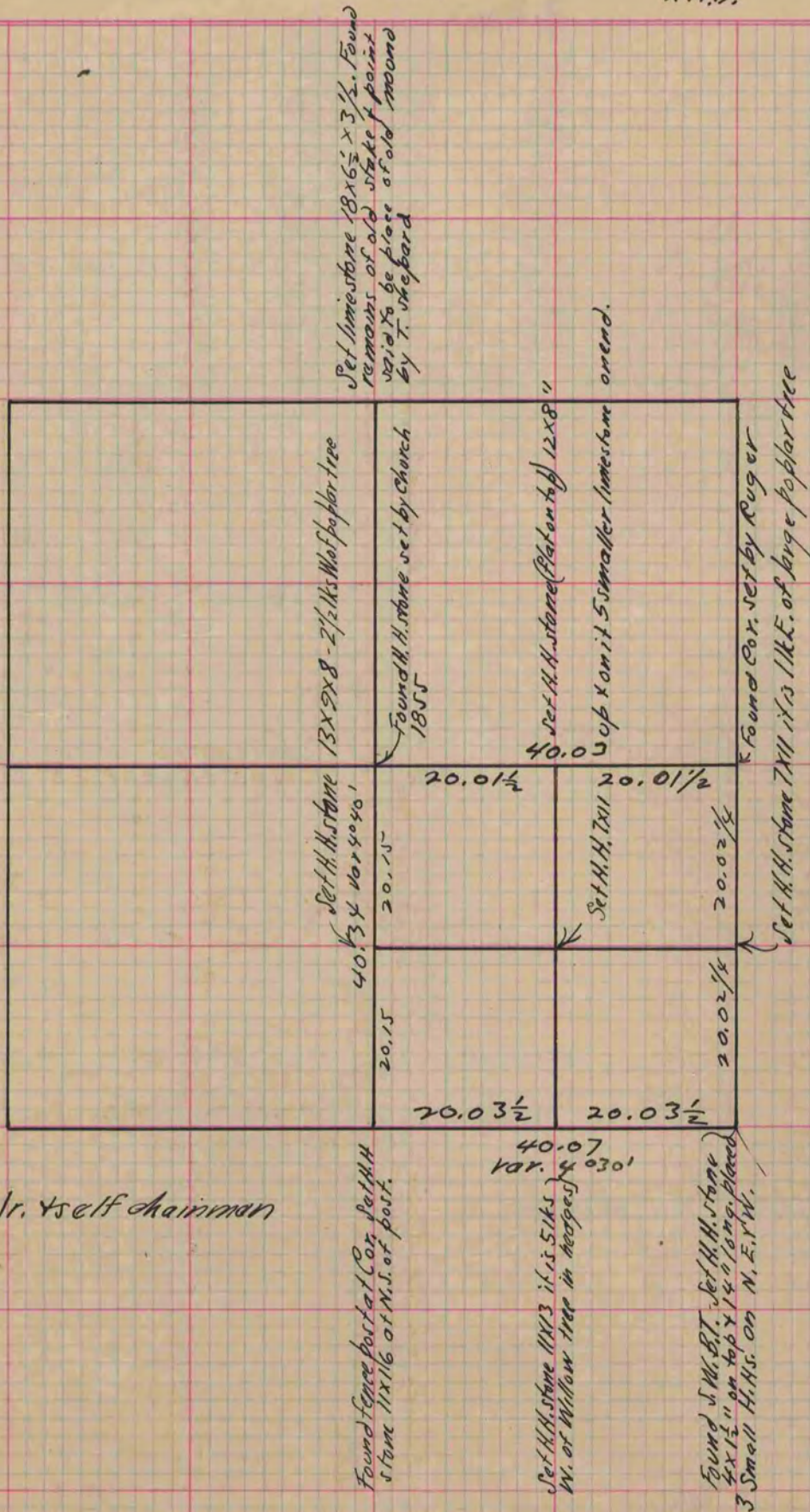

S. Lake Jr. & self chairman

Copied from page 250 Vol. 2. County Surveyors Record.