

# PLAT AND RECORD

Of a Survey on Section 35 T 4 R 14 E. of the 4 P. M. in Clinton Township

Rock County, Wisconsin, made June the 27<sup>th</sup> & 28<sup>th</sup> 1881

I hereby certify that the following is a correct record of said survey as made by me.

COUNTY BUILDING  
CITY OF JANESVILLE

(Signed) R. K. Lee  
R. H. B.

County Surveyor.

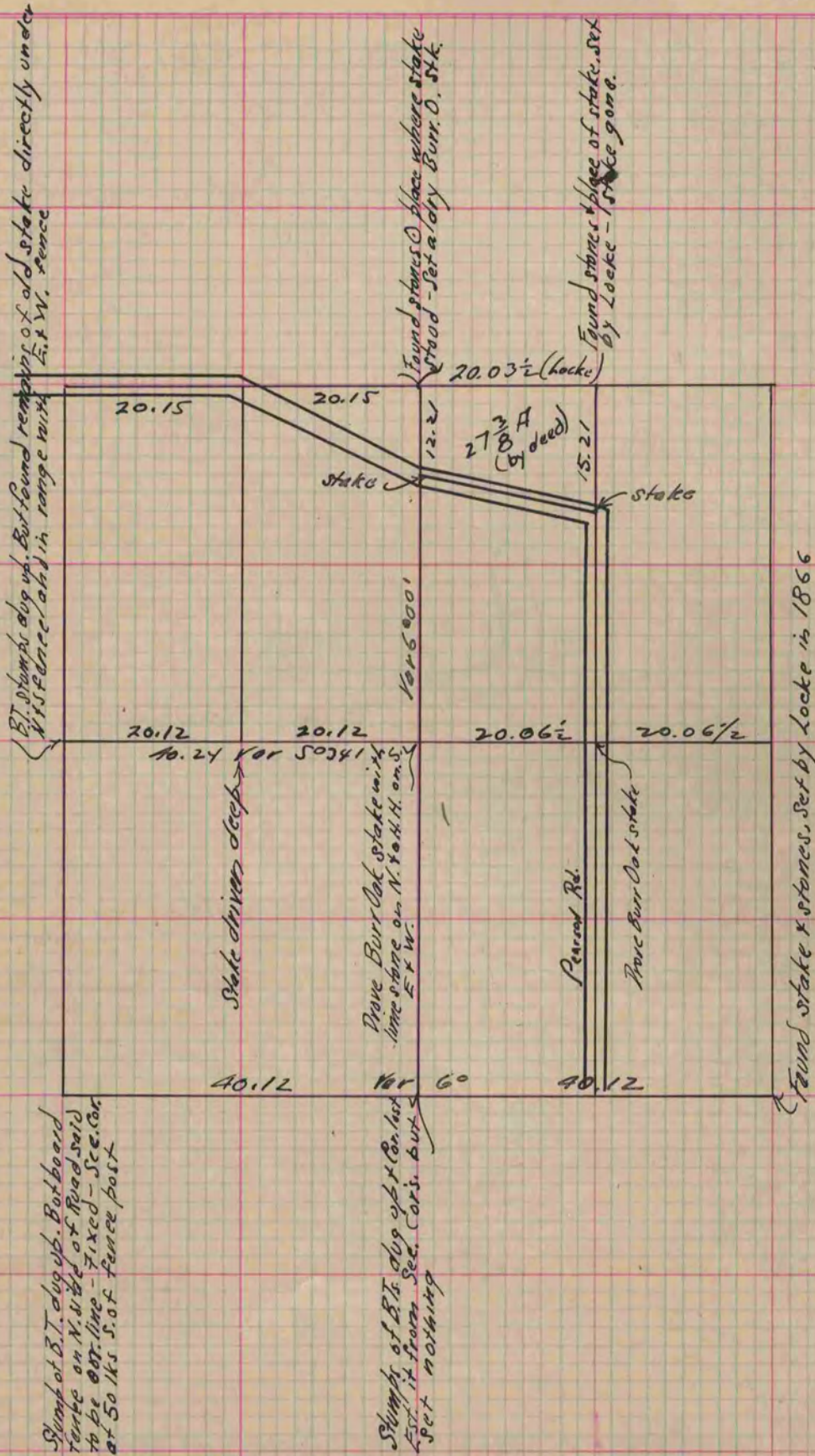

Copied from P. 268 Vol. 2 County Surveyors Record.