

# PLAT AND RECORD

487  
V-2

**MICROFILMED**

COUNTY BUILDING  
CITY OF JANESVILLE

Of a Survey on Section 27 T 3 R 12 E. of the 4 P. M. in Janesville Township

Rock County, Wisconsin, made April the 2 1894

I hereby certify that the following is a correct record of said survey as made by me.

(Signed) O.G. Bleedorn  
R.H.B. County Surveyor.

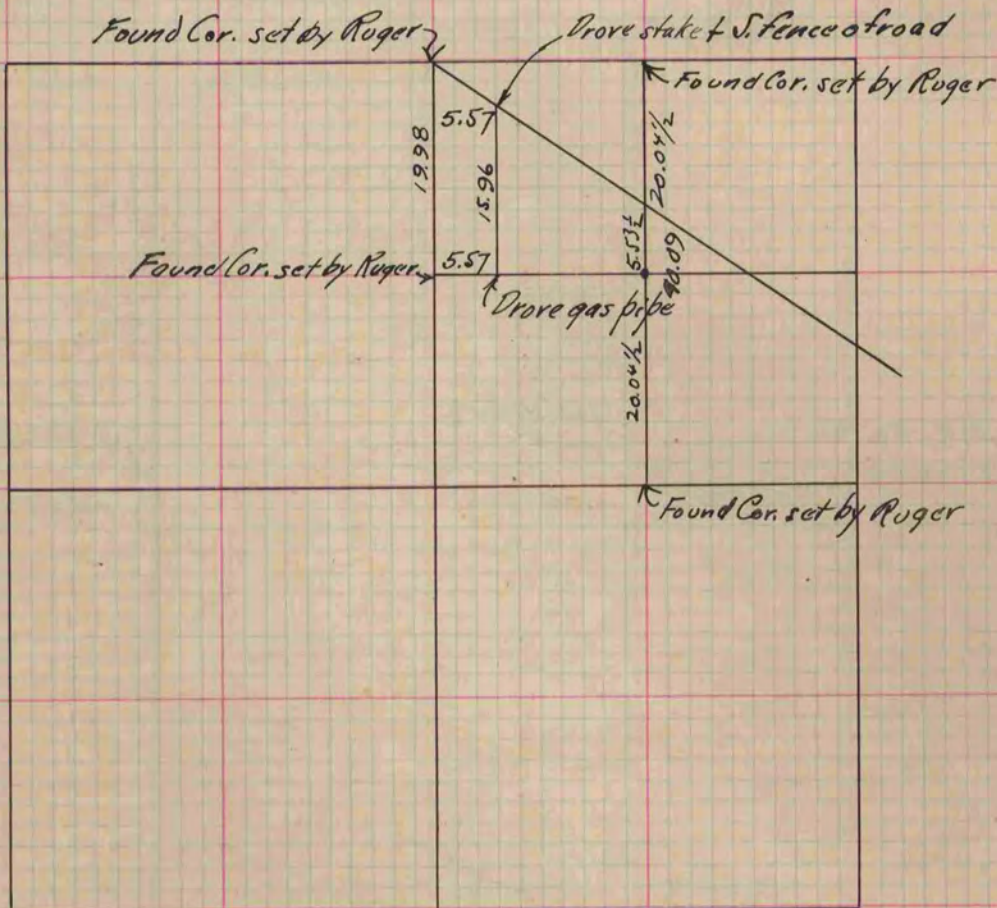

Copied from P. 377 Vol. 2. County Surveyors Record.