

MICROFILMED

PLAT AND RECORD

COUNTY BUILDING
CITY OF JANESVILLE

Of a Survey on Section 24 T 4 R 12 E. of the 4 P. M. in Fulton Township

Rock County, Wisconsin, made _____ the _____ 19____

I hereby certify that the following is a correct record of said survey as made by me.

(Signed) P.F. Brown
R. H. B. County Surveyor.

Copied from Notes of O. G. Bleedorn.

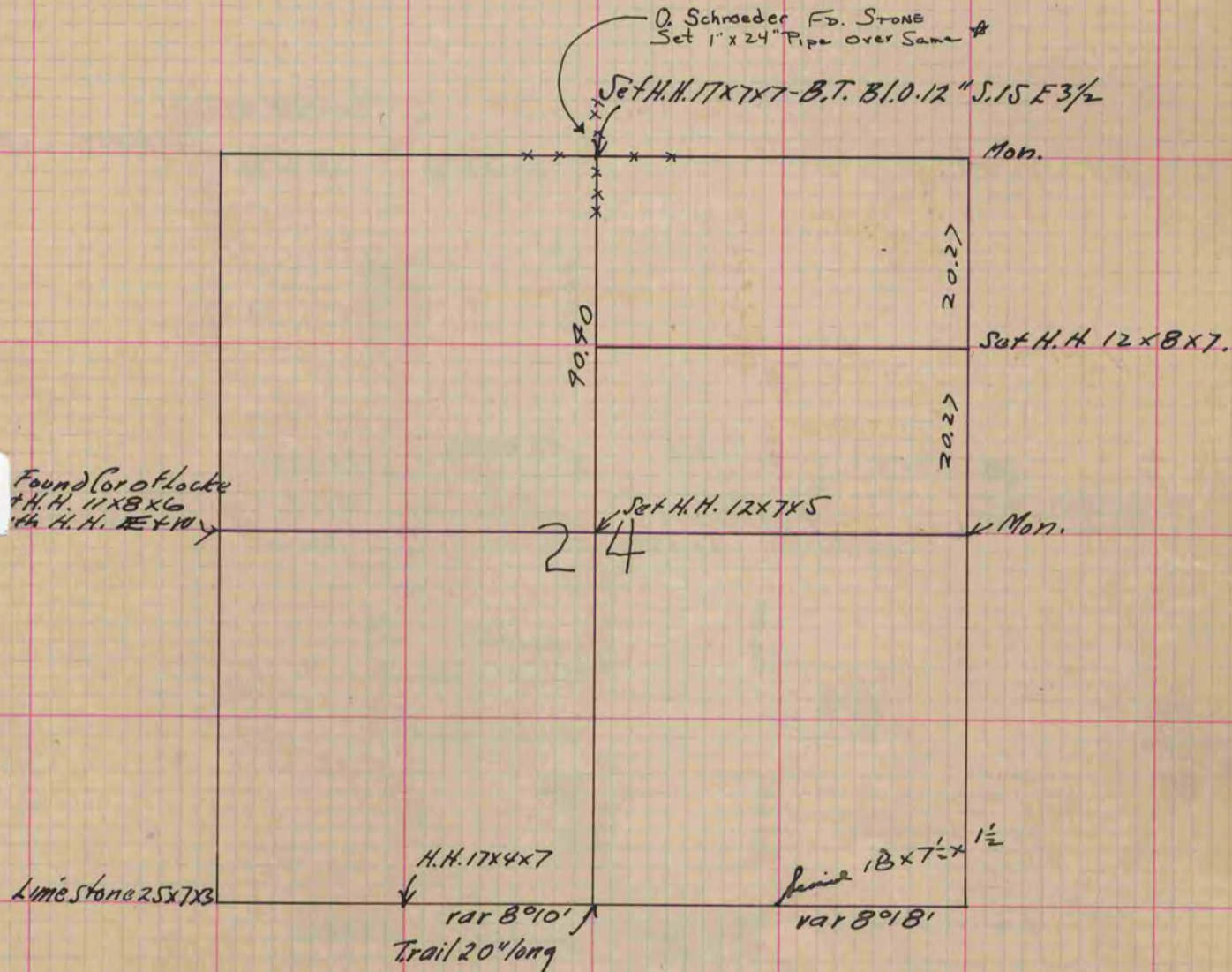

* Copied from Beloit Records
12/11/75
G. Q.

Copied from P. 382 Vol. 2. County Surveyors Record.