

440  
V-4

# PLAT AND RECORD

COUNTY BUILDING  
CITY OF JANESVILLE

Of a Survey on Section 14 T 4 R 10 E. of the 4 P. M. in Union Township

Rock County, Wisconsin, made Aug the 17 19 1970

I hereby certify that the following is a correct record of said survey as made by me.

*Robt. B. ...*

County Surveyor.

**MICROFILMED**

W. 1/4 Sec 14-4-10

Set mon. box over cut stone 7/10/70

RE-REFERENCED RT  
Box TAKEN OUT BY COUNTY HWY. DEPT. ML

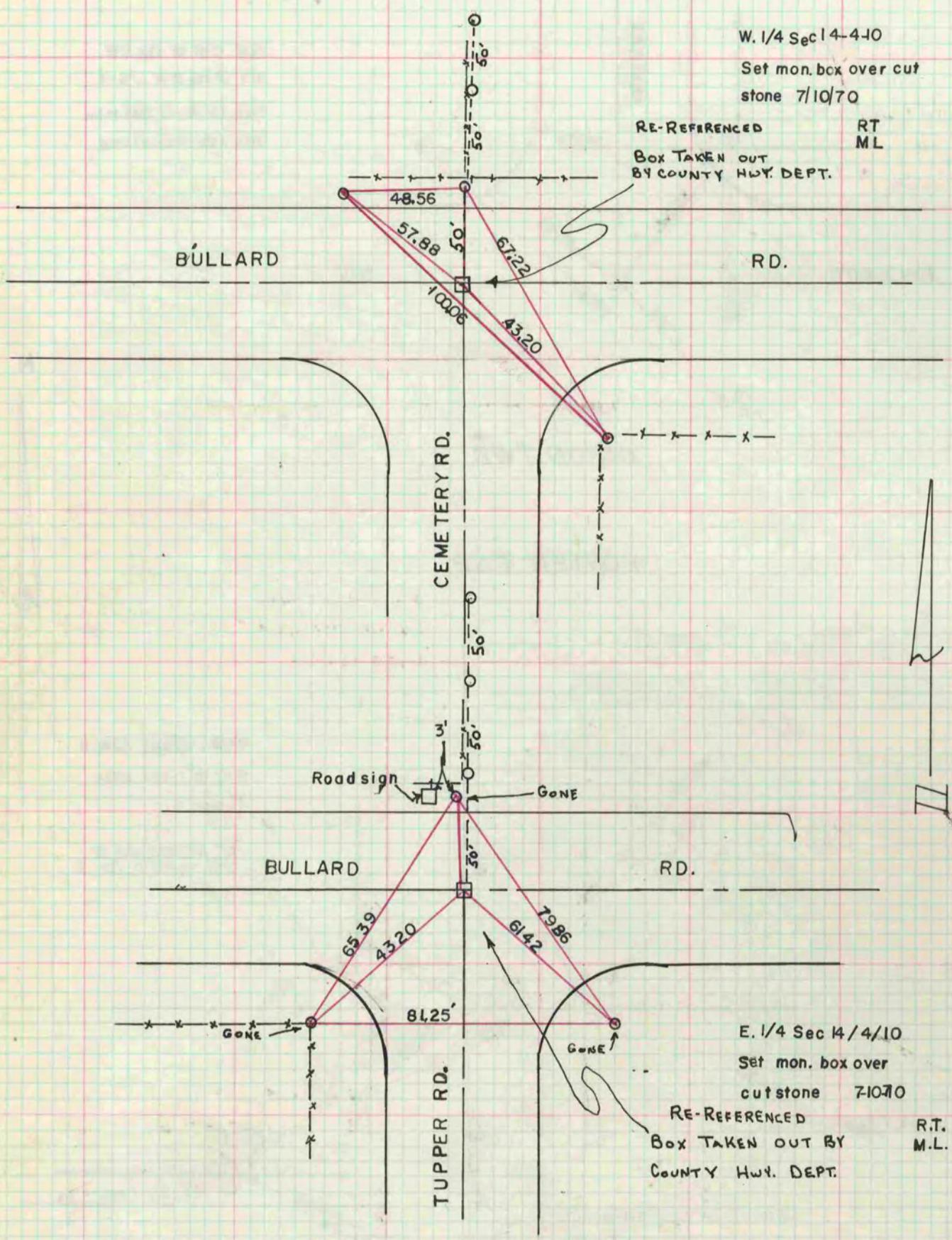

E. 1/4 Sec 14/4/10

Set mon. box over cutstone 7-10-70

RE-REFERENCED R.T.  
Box TAKEN OUT BY M.L.  
COUNTY HWY. DEPT.