

PLAT AND RECORD

COUNTY BUILDING
CITY OF JANESVILLE

COUNTY BUILDING
CITY OF JANESVILLE

Of a Survey on Section 20 & 21 T 4 N. R 13 E. of the 4 P. M. in MILTON Township

Rock County, Wisconsin, made NOVEMBER the 12 1969

I hereby certify that the following is a correct record of said survey as made by me.

Robert B. Hutton Jr.

County Surveyor.

MICROFILMED

THE GEO. S. BARNARD COMPANY, ST. LOUIS

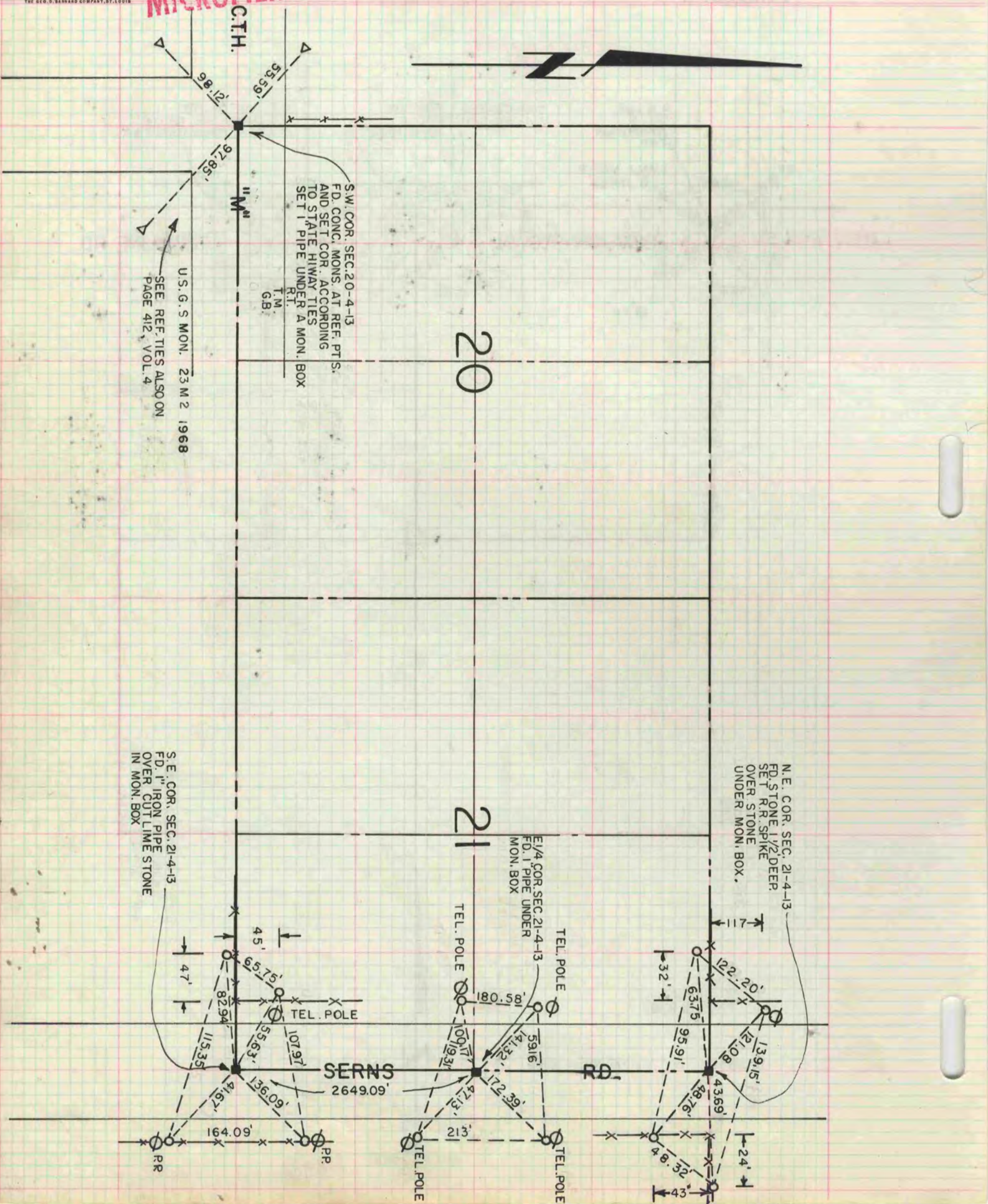

U.S.G.S MON. 23 M 2 1968
SEE REF. TIES ALSO ON
PAGE 412, VOL. 4

S.E. COR. SEC. 21-4-13
FD. 1" IRON PIPE
OVER CUT LIME STONE
IN MON. BOX

S.W. COR. SEC. 20-4-13
FD. CONC. MONS. AT REF. PT. S.
AND SET COR. ACCORDING
TO STATE HIGHWAY TIES
SET 1 PIPE UNDER A MON. BOX
T.M.
G.B.

N.E. COR. SEC. 21-4-13
FD. STONE 1/2 DEEP
SET R.R. SPIKE
OVER STONE
UNDER MON. BOX.

E/4 COR. SEC. 21-4-13
FD. 1 PIPE UNDER
MON. BOX

SERNS RD.
2649.09'

RD.

RR

RR

TEL. POLE

TEL. POLE

TEL. POLE

TEL. POLE

TEL. POLE

TEL. POLE

TEL. POLE

TEL. POLE

TEL. POLE