

PLAT AND RECORD

Of a Survey on Section 19 T 4 R 11 E. of the 4 P. M. in PORTER Township

Rock County, Wisconsin, made SEPTEMBER the 9th 1971

I hereby certify that the following is a correct record of said survey as made by me.

COUNTY BUILDING
CITY OF JANESVILLE

County Surveyor.

THE GEO. D. BARRARD COMPANY, ST. LOUIS

MICROFILMED

BK. 152 A, P. 55-56

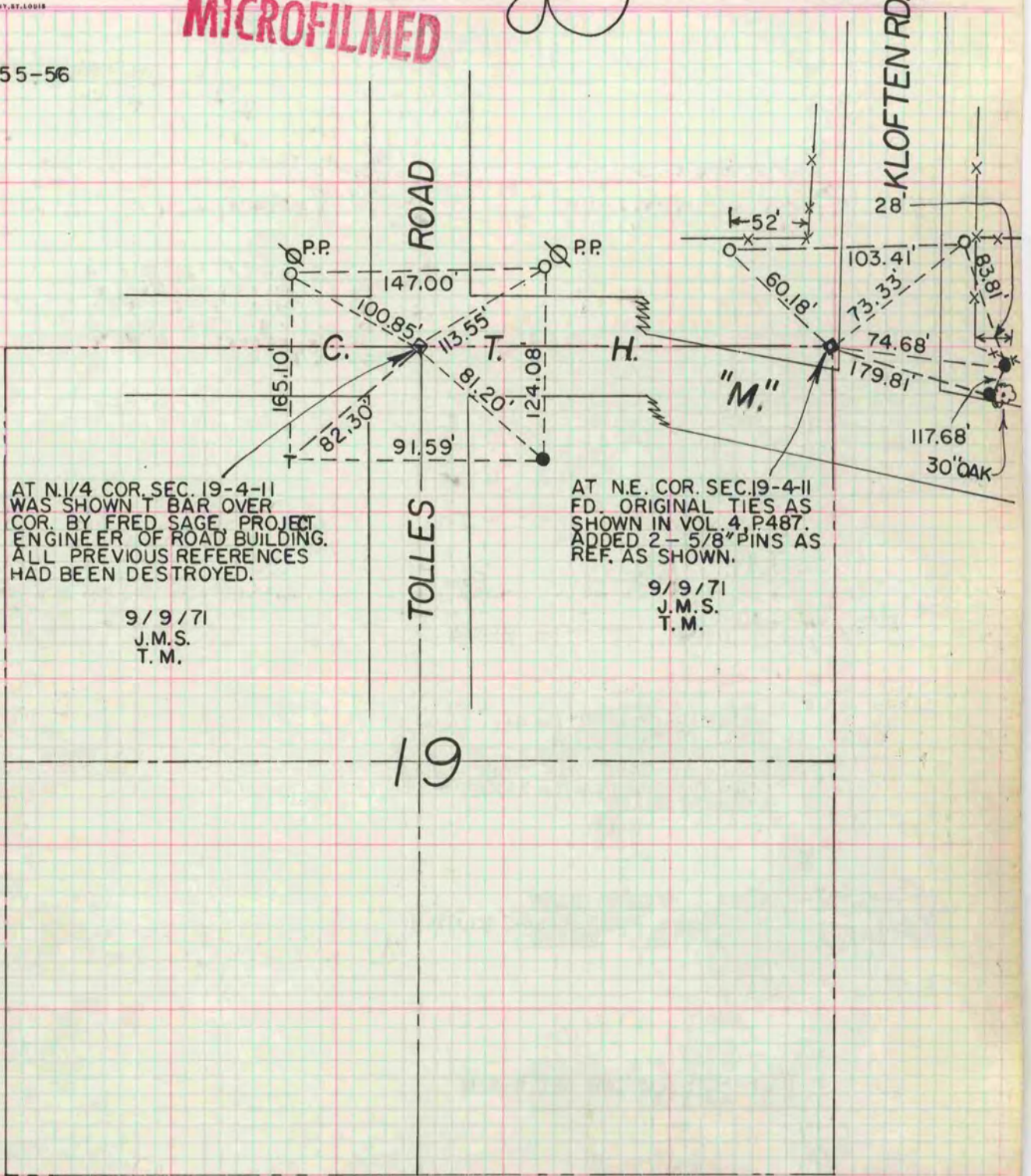

AT N. 1/4 COR. SEC. 19-4-11
WAS SHOWN T BAR OVER
COR. BY FRED SAGE, PROJECT
ENGINEER OF ROAD BUILDING.
ALL PREVIOUS REFERENCES
HAD BEEN DESTROYED.

9/9/71
J.M.S.
T.M.

AT N.E. COR. SEC. 19-4-11
FD. ORIGINAL TIES AS
SHOWN IN VOL. 4, P. 487.
ADDED 2 - 5/8" PINS AS
REF. AS SHOWN.

9/9/71
J.M.S.
T.M.

MONUMENT KEY

- T = T BAR IRON STAKE
- = 5/8" IRON PIN
- = 1" IRON PIPE