

Of a Survey on Section 21 T 4 R 14 E. of the 4 P. M. in LIMA Township

Rock County, Wisconsin, made JULY the 16th 1974

I hereby certify that the following is a correct record of said survey as made by me.

MICROFILMED

Hugh J. Lee
County Surveyor.

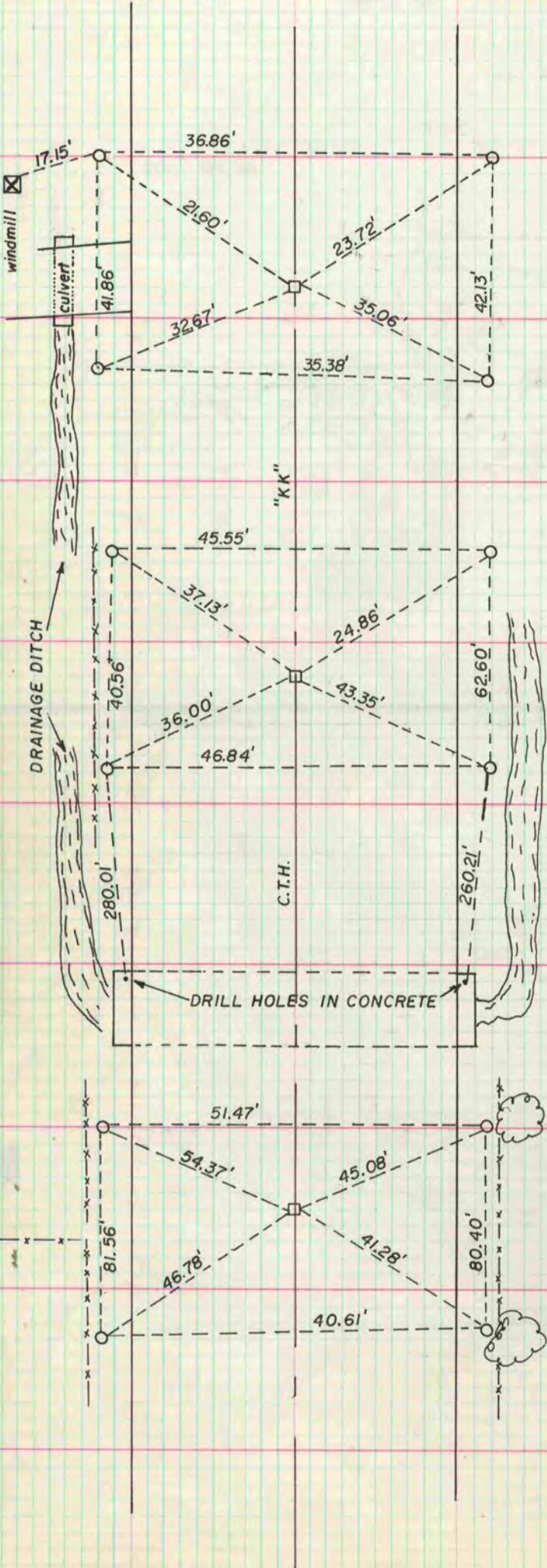

AT N.W. COR. SEC. 21-4-14, FD. 2 H.H.s. AND I.L.S.
7-16-74 W.K. J.L.

REF. AND SET MON. 7-17-74 M.L. J.L. B.L.

OCT 6, 1975 SET BERNTSEN W-1-B
MONUMENT DAB

AT N.W. COR. OF S.W. 1/4 OF N.W. 1/4 FD. STAKE
SURROUNDED BY 4 H.H.s. W.K. J.L.

SET MON. AND REF. M.L. J.L. B.L. 7-16-74

BOOK 170
PAGES III-113

AT W 1/4 COR. SEC. 21-4-14 FD. 3 H.H.s. AND I.L.S.

7-16-74 W.K. J.L.

SET MON. AND REF M.L. J.L. B.L. 7-17-74