

# PLAT AND RECORD

COUNTY BUILDING  
CITY OF JANESVILLE

Of a Survey on Section 8 T 1 R 10 E. of the 4 P. M. in Avon Township

Rock County, Wisconsin, made August the 17 1976

I hereby certify that the following is a correct record of said survey as made by me

**MICROFILMED**



W<sup>1</sup>/<sub>4</sub> Cor. Sec. 8  
Fd. Limestone 1 1/2 x 7 x 3"

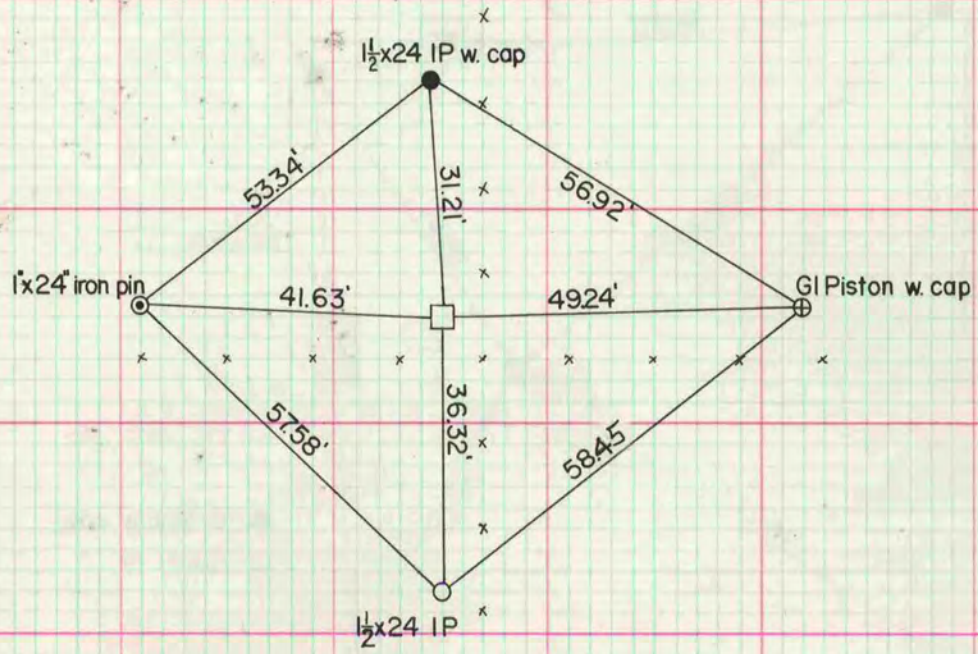

NE<sup>1</sup>/<sub>4</sub> Cor. SE<sup>1</sup>/<sub>4</sub> of the  
SW<sup>1</sup>/<sub>4</sub> of Sec. 8

Fd. 1' deep sandstone 12 x 7 x 5"

