

PLAT AND RECORD

COUNTY BUILDING
CITY OF JANESVILLE

RECORD BOOK
JANESVILLE
MILTON

Of a Survey on Section 2 T 4 N. R 13 E. of the 4 P. M. in Milton Township

Rock County, Wisconsin, made October the 1976

I hereby certify that the following is a correct record of said survey as made by me.

MICROFILMED



County Surveyor.

NW corner section 2
Milton Twp.
Found 1/2" pin in concrete

O = 1 1/2"x24" iron pipe

Heavy brush row

NOTE: pk's are 1.0' off sets

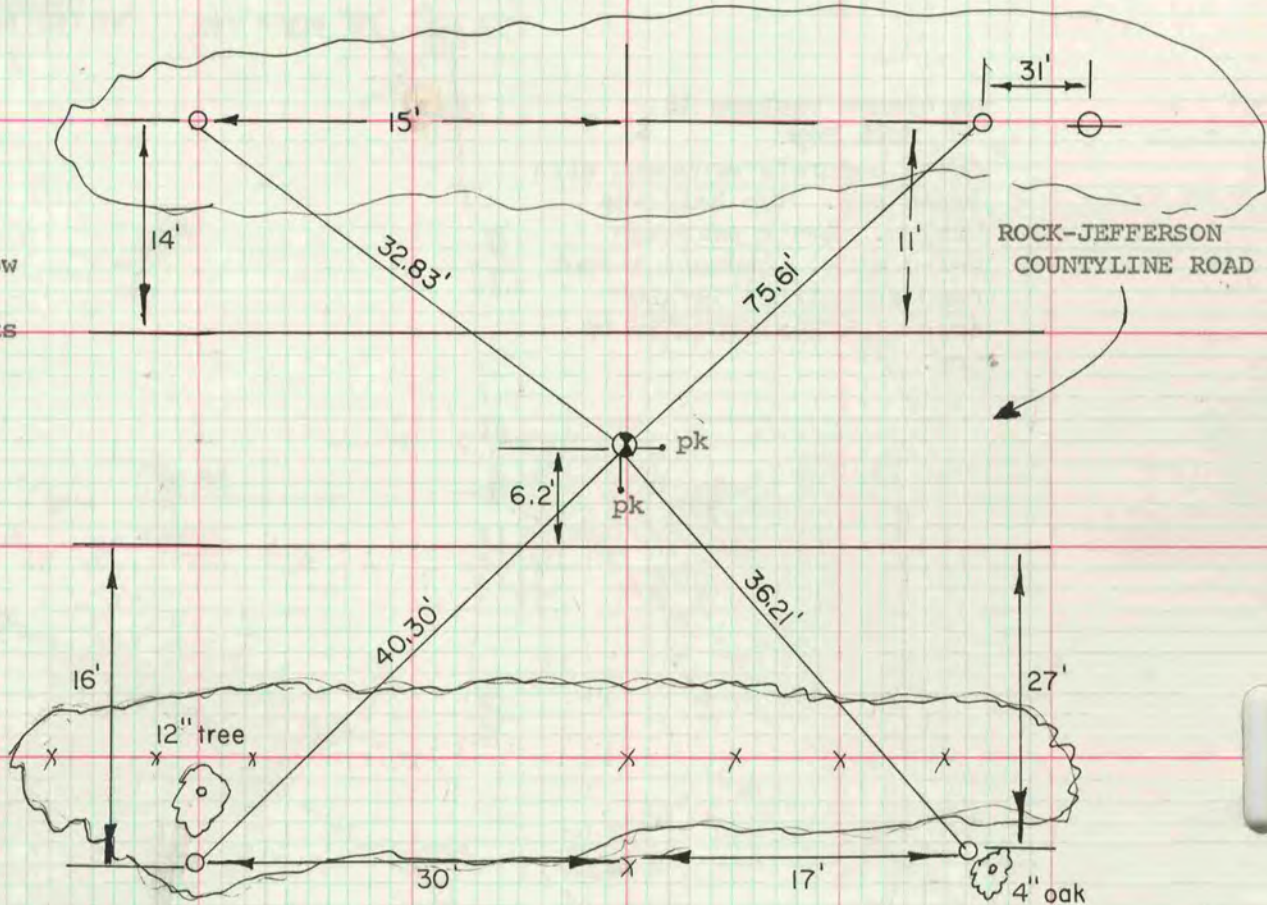

NE corner section 2
Milton Twp.

The NE Cor was set at record distance from the SW Cor Sec 36 Sumner Twp. and on line with the NW Cor Sec 2 and the SW Cor Sec 36 Sumner Twp.

● = 1 1/2"x24" iron pipe with cap

O = 1 1/2"x24" iron pipe

6" maple

