

PLAT AND RECORD

COUNTY BUILDING
CITY OF JANESVILLE

Of a Survey on Section 22 T 1 N R 14 E. of the 4 P. M. in CLINTON Township

Rock County, Wisconsin, made Sept the 30

I hereby certify that the following is a correct record of said survey as made by me.

MICROFILMED

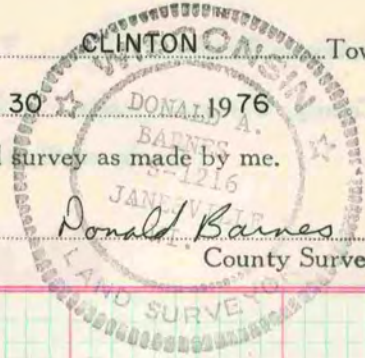

COUNTY BUILDING
CITY OF JANESVILLE

Center sec 22 Clinton Twp.

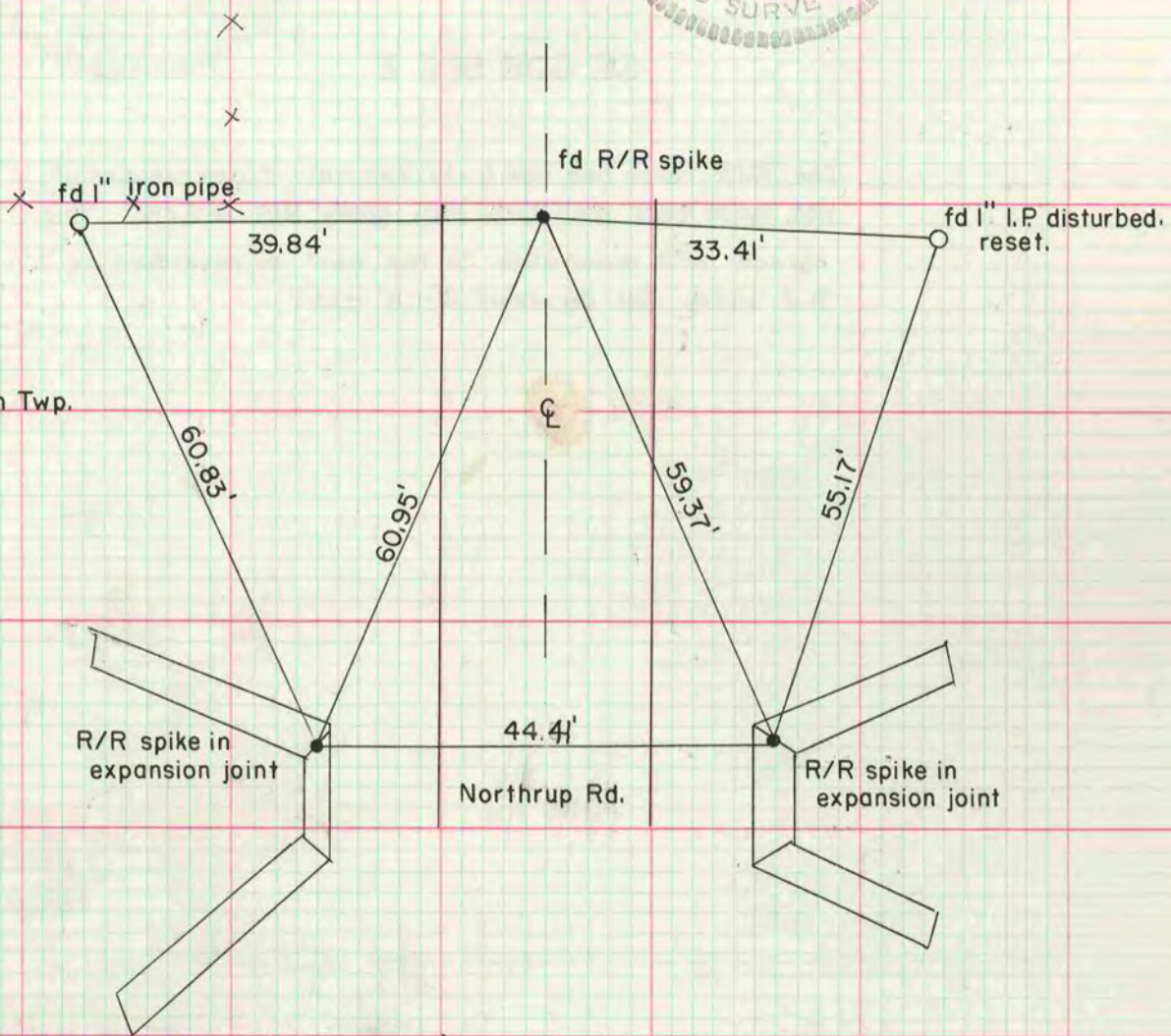

N 1/4 cor sec 22 Clinton Twp.

former county surveyor dug and fd. nothing. set on line with center of sec 22 and S 1/4 cor sec 22 at line of occupation.

