

290 VOL. 5 PLAT AND RECORD

Of a Survey on Section 26, 28 T 4 N R 14 E. of the 4 P. M. in LIMA Township
 Rock County, Wisconsin, made JUNE 6 1977

I hereby certify that the following is a correct record of said survey as made by me.
 COUNTY BUILDING
 CITY OF JANESVILLE

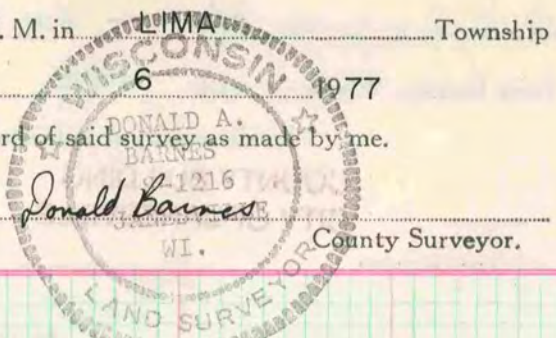

MICROFILMED

W 1/4 cor sec 26-4-14
 Dug and fd 0.5' deep 1"x1"x30"
 iron buggy axle \odot by 3 HH and
 1 limestone. set alum. mon.

$\odot = 1'' \times 24''$ I.P.

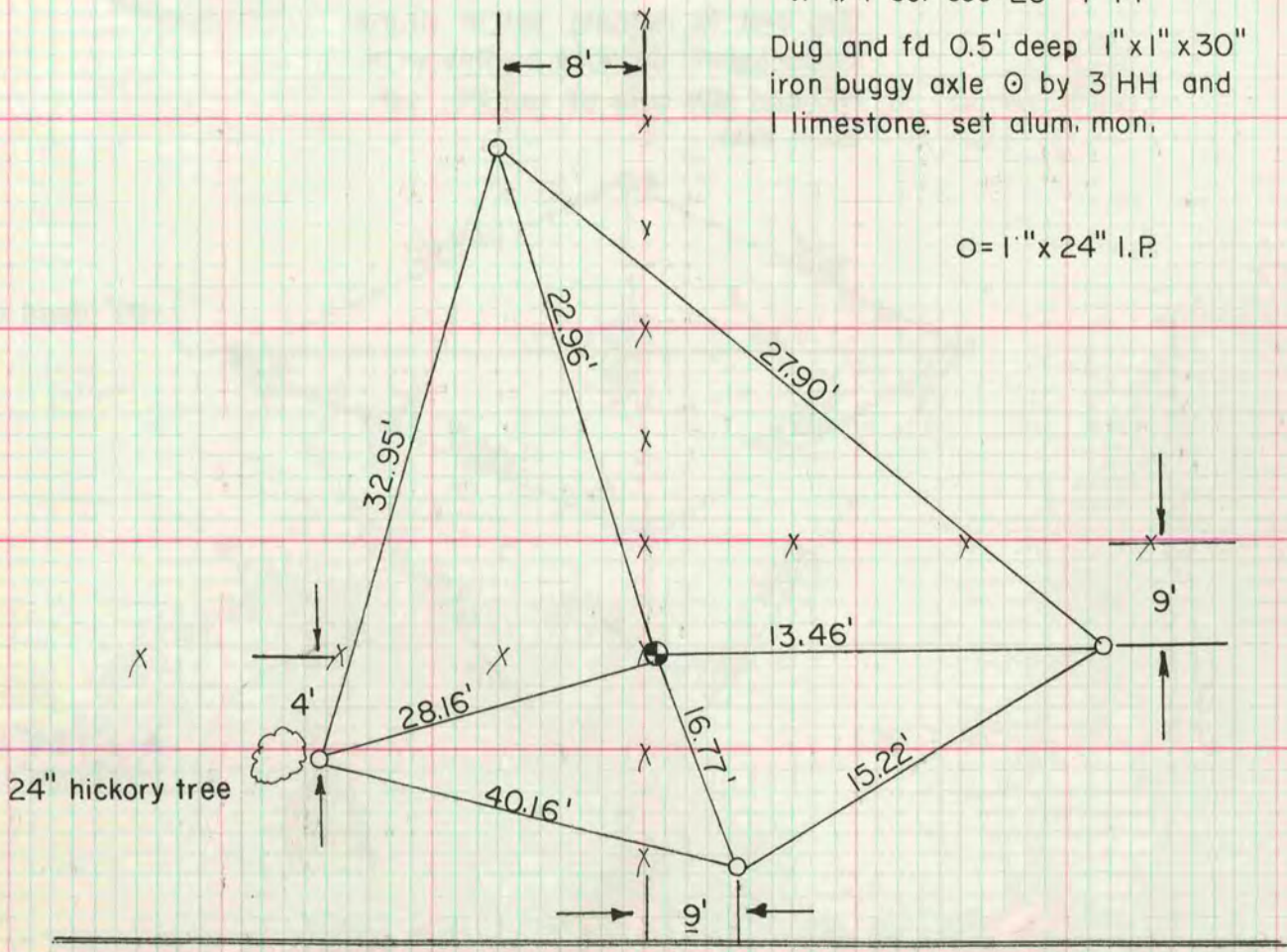

SE cor sec 28-4-14
 former county surveyor dug and fd nothing
 I also dug and fd nothing. set cor at rec
 distance from S 1/4 cor sec 27 and occupation
 to the north. N/S fence line is a record
 distance from S 1/4 cor sec 27.
 set alum mon

