

Of a Survey on Section 27 T 1 R 11 E. of the 4 P. M. in Newark Township
Rock County, Wisconsin, made on or before SEPT the 28 19 77

I hereby certify that the following is a correct record of said survey as made by me.

COUNTY BUILDING
CITY OF JANESVILLE



NE. COR. SEC. 27 T. 1 R. 11 E.

FD. NAIL & 1" I.P. FD. CUT STONE SET ALUM. MON.

2.0' DEEP

- 1" X 24" I.P.
- G-1 MON WITH CAP

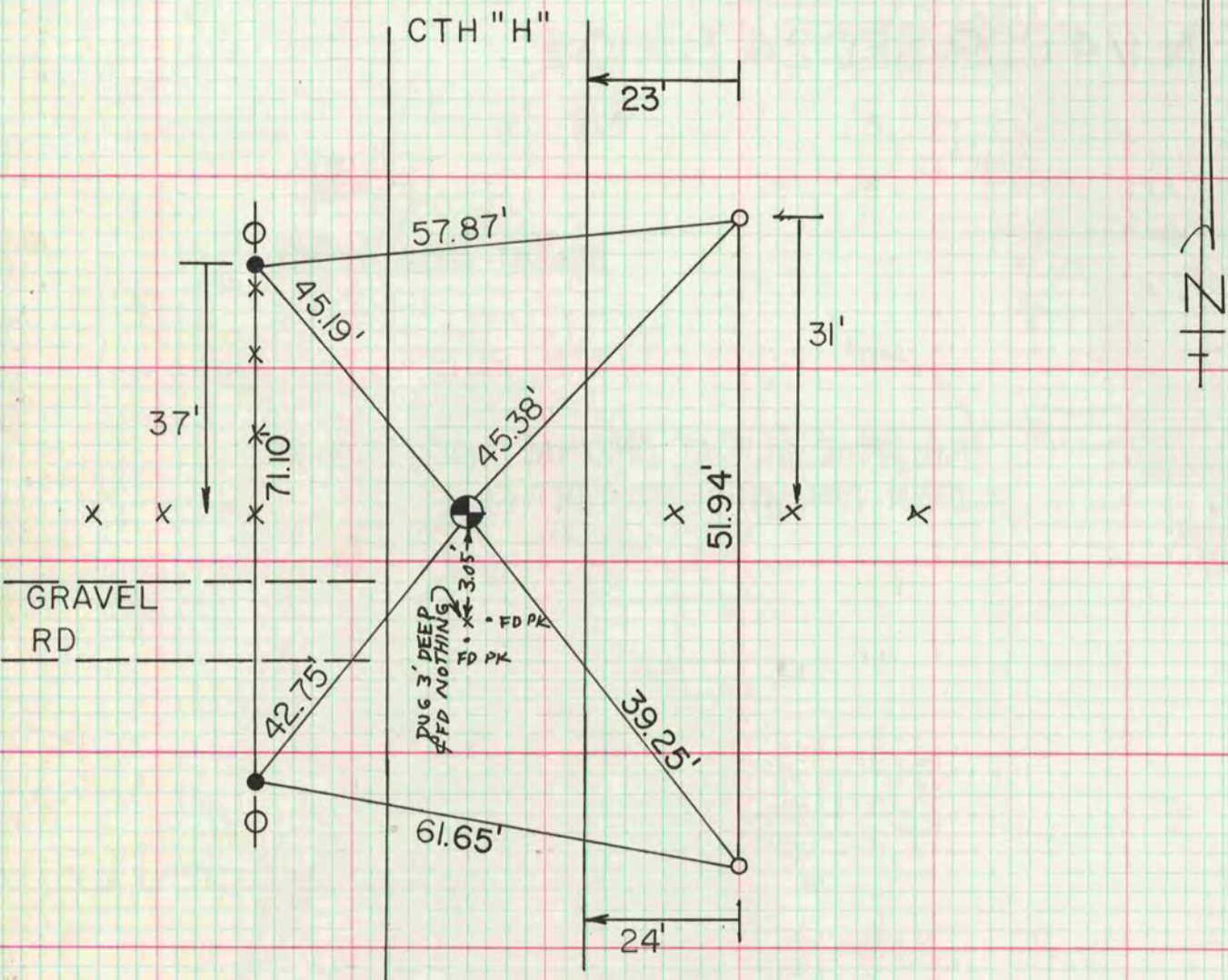

MICROFILMED