

PLAT AND RECORD

Of a Survey on Section 7 T 4 R 10 E. of the 4 P. M. in UNION Township
Rock County, Wisconsin, made NOV the 14 19 77

I hereby certify that the following is a correct record of said survey as made by me.

COUNTY BUILDING
CITY OF JANESVILLE

DONALD A. BARNES
S-1216
JANESVILLE
WI.
County Surveyor.

NW COR. SEC 7 T4 R10E.

SET ON LINE WITH SE. COR. SEC. 12 & E. 1/4 SEC. 12 GREEN CO. AT SINGLE PROPORTIONATE DISTANCE. WHILE EXCAVATING FOR THE OTHER SEC CORNERS AN OLD ASPHALT RD. WAS USUALLY FD. BELOW THE EXISTING SURFACE. THE TERRAIN AND THE FACT THAT THE OLD ASPHALT WAS NOT FD. INDICATES THAT THE COR. WAS PROBABLY DESTROYED DURING THE ROAD CONSTRUCTION BY GREEN CO. FIVE YEARS AGO.

O-1 1/4" X 24" IP

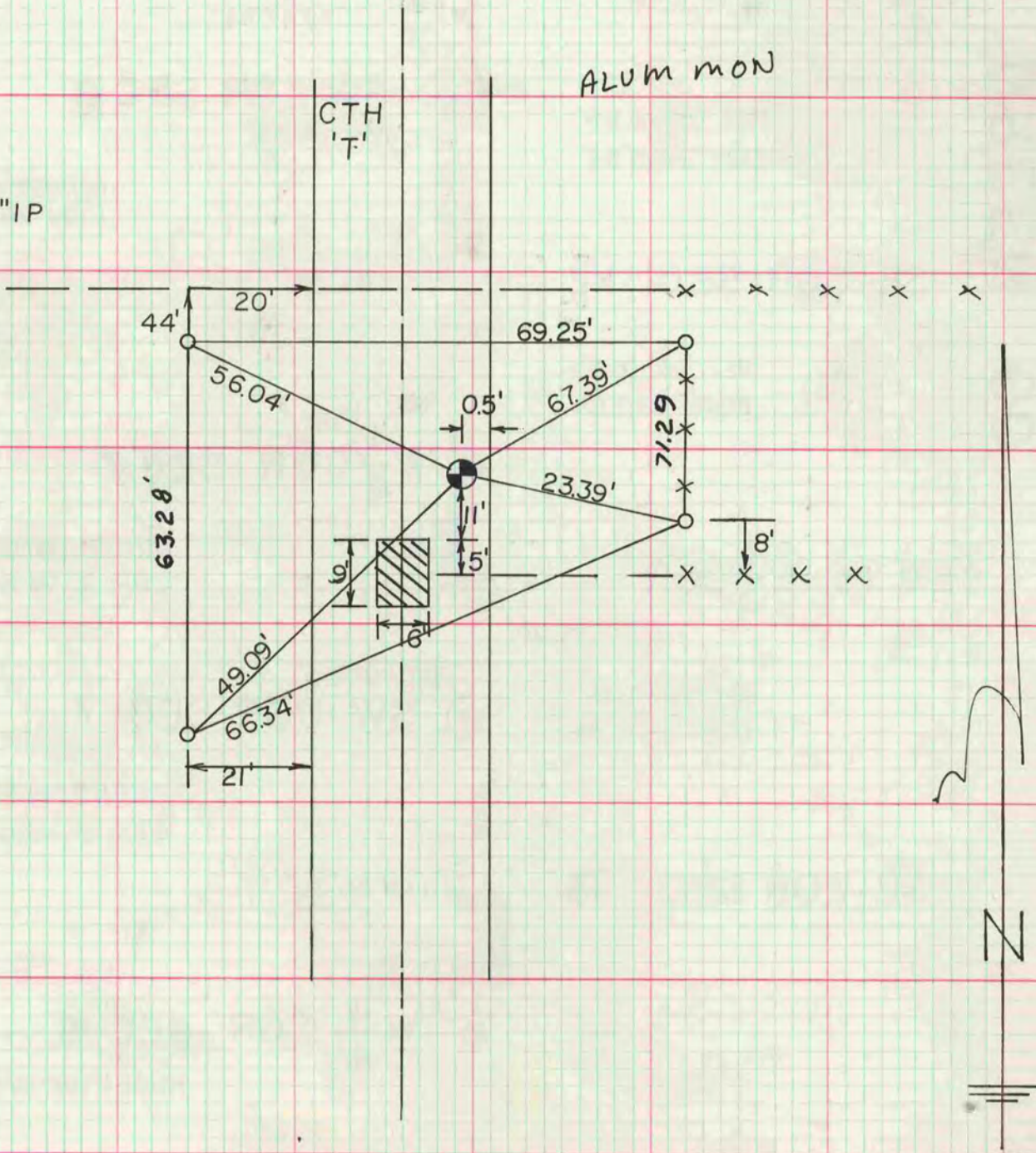

MICROFILMED