

PLAT AND RECORD

COUNTY BUILDING  
CITY OF JANESVILLE

Of a Survey on Section 24 T 3 R 9 E. of the 4 P. M. in Township

Rock County, Wisconsin, made NOV the 10 19 77

I hereby certify that the following is a correct record of said survey as made by me.

County Surveyor.

INFORMATION RECEIVED FROM DICK TALARCZYK  
E1/4 COR SEC 24 T3 R9E

GREEN COUNTY

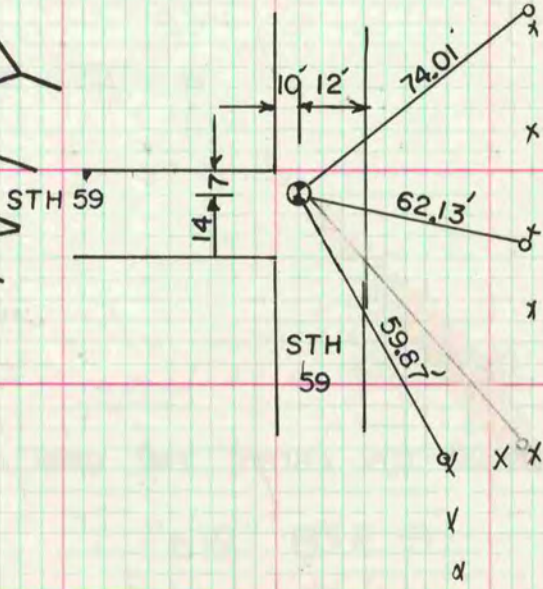

CORNER SET BY PROPORTIONATE  
MEASUREMENT & EXISTING PHYSICAL  
EVIDENCE

- 10# 30" IRON ROD
- ⊗ ALUM MON

NE COR SEC 24 T3 R9E

CORNER SET BY PROPORTIONATE MEASUREMENT  
& EXISTING EVIDENCE

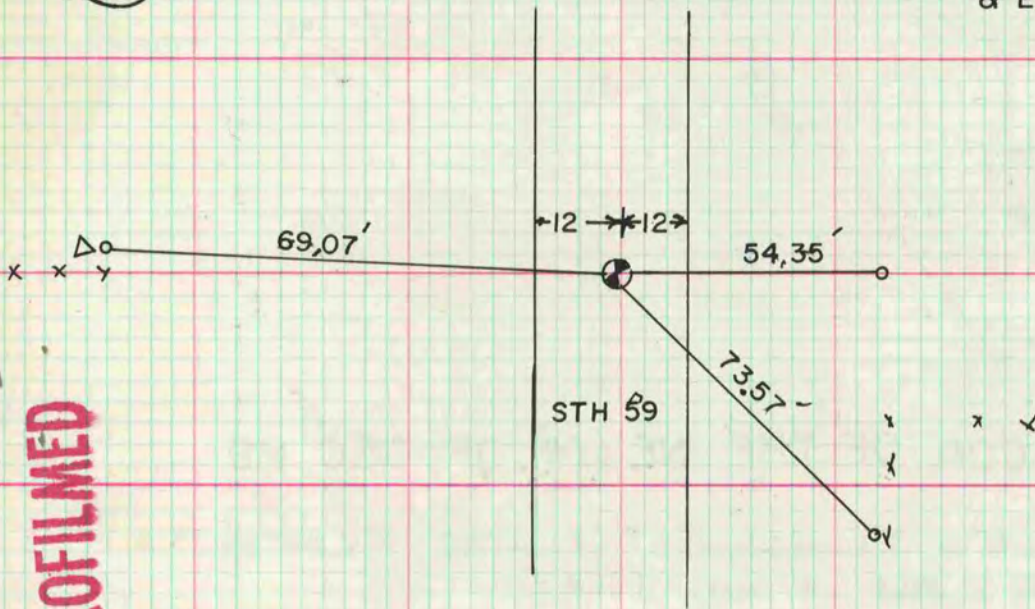

- 10# 30" IRON ROD
- ⊗ ALUM MON
- △ R/W POST

MICROFILMED