

PLAT AND RECORD

VOL. 5

Of a Survey on Section 12 T 2 R 12 E. of the 4 P. M. in ROCK Township
Rock County, Wisconsin, made JULY the 17 19 78

I hereby certify that the following is a correct record of said survey as made by me.

COUNTY BUILDING
CITY OF JANESVILLE

Donald Barnes
DONALD BARNES
28-1216
JANESVILLE
WI.
LAND SURVEYOR
County Surveyor.

S/W 4 COR. SEC. 12

MICROFILMED

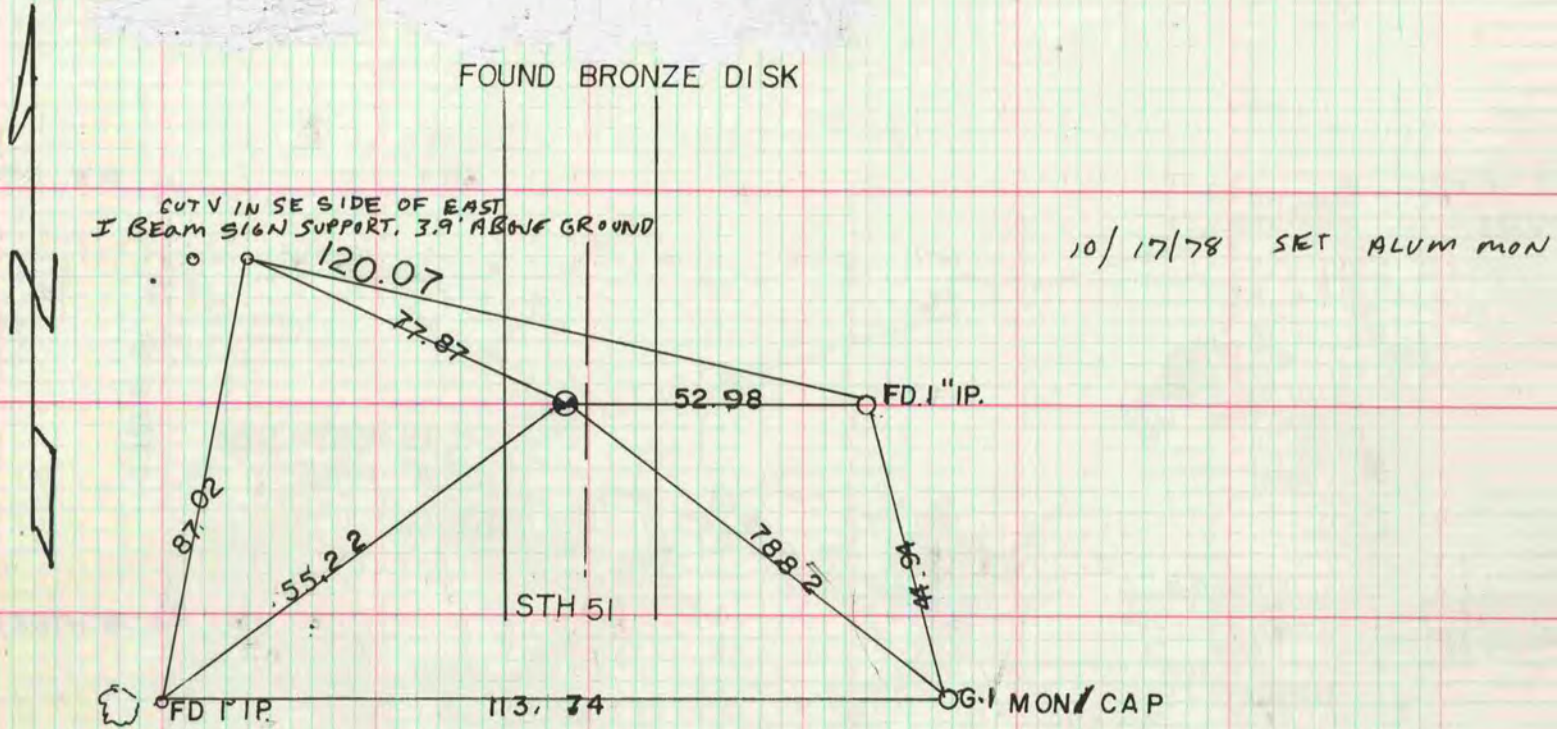

W 1/4 COR. SEC. 12

CORNER WAS DESTROYED BY ROAD CONSTRUCTION. SET CORNER FROM CSM VOL 3 PG 341, THE CORNER IS ON LINE WITH THE SW & W 1/16 COR OF THE SW 1/4 OF SEC 12. ALSO THE ANGLE FROM THE SW TO THE CENTER IS IN HARMONY WITH THE REC ANGLE

ST.H. 51

