

PLAT AND RECORD

COUNTY BUILDING
CITY OF JANESVILLE

Of a Survey on Section 17 T 4 R 11 E. of the 4 P. M. in PORTER Township
Rock County, Wisconsin, made AUGUST the 16 1979

I hereby certify that the following is a correct record of said survey as made by me.



Donald Barnes
County Surveyor.

CENTER OF SEC 19

FD 1 1/4" x 24" I.P. OVER O.I.P. REPLACED WITH ALUM MON

SW COR SEC 17

FOUND 3/4" x 22" BOLT 2' DEEP WITH LARGE HH. ON WEST SIDE. REPLACED BOLT WITH C.I. MON. IN LINE WITH C. OF C.T.H."M" TO THE WEST.

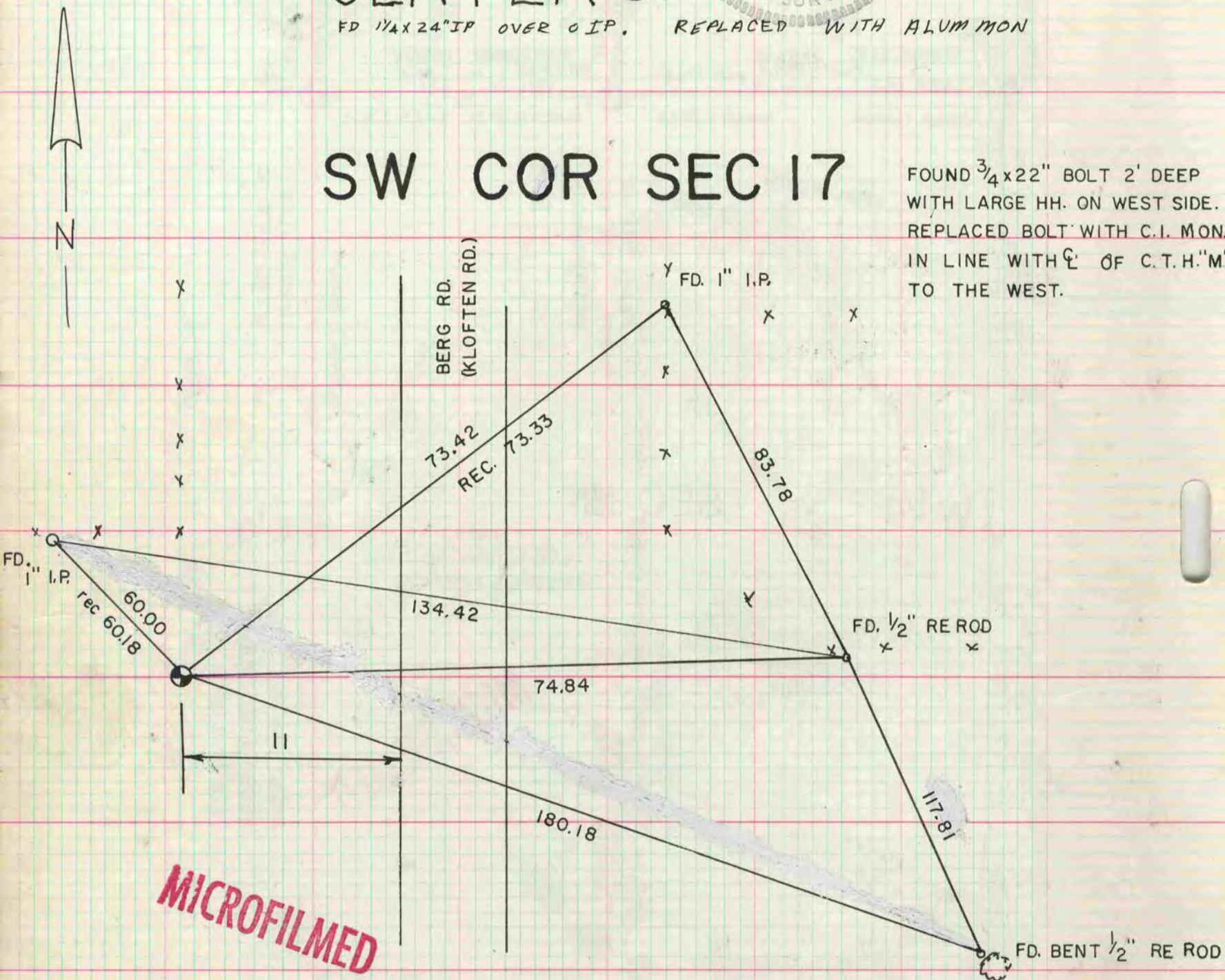

MICROFILMED

REFERENCE C.S.M. SURVEY MONUMENT

FOR ROAD CONSTRUCTION

- SET 1 1/4" x 24" I.P.
- FD. 1/2" RE-ROD

