

PLAT AND RECORD

567
VOL. 5

Of a Survey on Section 29 T 4 R 11 E. of the 4 P. M. in PORTER Township
Rock County, Wisconsin, made AUGUST the 24 19 79

I hereby certify that the following is a correct record of said survey as made by me.

COUNTY BUILDING
CITY OF JANESVILLE

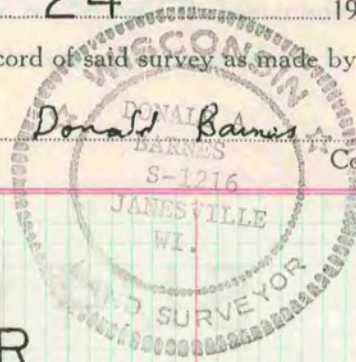

N 1/4 COR

FD CI MON

RUGER 2645.94
N2°44'00"W 2648.87

FD ALUM MON 1328.02
N87°15'05E

FD IP

N87°14'04"E 1326.79

FD IP

N87°14'04"E 1332.81

N87°12'22"E 1331.96

W 1/4 COR

RUGER 1326.43

RUGER 1326.43

RUGER 1330.89

RUGER 1330.89

E 1/4 COR

RUGER 2668.05
S2°44'00"E 2673.91

DID NOT SET ANYTHING

FD ALUM MON

H LEE 2665.02
RUGER 2661.78

90°07'29" H LEE

SW COR

S 1/4 COR

MICROFILMED

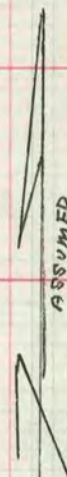

E 1/4 CORNER OF SEC 29

E 1/4 COR

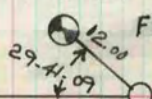

FD H.H. 03 H.H. & LIMESTONE SET ALUM MON ON TOP OF STONE

1/6th COR

FD BENT IP REPLACED WITH 26 BOLT

FD IP AS REFERENCED IN VOL 4 PAGE 3