

586

22 VOL. 6

PLAT AND RECORD

CITY OF JANESVILLE
COUNTY BUILDING

Of a Survey on Section 30 T 4 R 14 E. of the 4 P. M. Township

Rock County, Wisconsin, made APRIL 9 1980

I hereby certify that the following is a correct record of said survey as made by me.

COUNTY BUILDING
CITY OF JANESVILLE

Donald Barnes

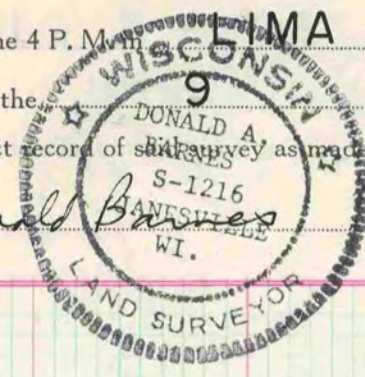

County Surveyor.

N 1/4 COR SEC 30

FOUND IRON PIPE SURROUNDED BY FOUR LARGE HARDHEADS.

MICROFILMED

NW COR

1052.8'±

1322.6'±

20'±

N 1/4 COR

000

DISTANCES ARE COPIED FROM KERCH'S FIELD BOOK

FIELD BOOK K-5 PAGE OCT. 4, 1911. KERCH.

000

SET GAS PIPE SURROUNDED BY FOUR HEADHEADS

1332.3'±

CENTER

FOUND PIECE OF IRON ROD UNDER NORTH-SOUTH FENCE INTERSECTION

