

PLAT AND RECORD

Of a Survey on Section 2, 22, 31, 33, 4 R. 12 E. of the 4 P. M. in FULTON Township

Rock County, Wisconsin, made SEPT. the

I hereby certify that the following is a correct record of said survey made by me.

COUNTY BUILDING
CITY OF JANESVILLE



SE COR SEC 2

FD. C.I. MON. INSTEAD OF ALUM. MON. IN REC. AT S. CORNER



NW COR SEC 22

FD. CONC. MON. W/BRASS CAP UNDER MON. BOX

W 1/4 COR SEC 31

FD PK NAIL ON SURFACE OF PVMT. 30" FD. H.H. PT. UP 0 BY H.H.'S. SET ALUM. MON.

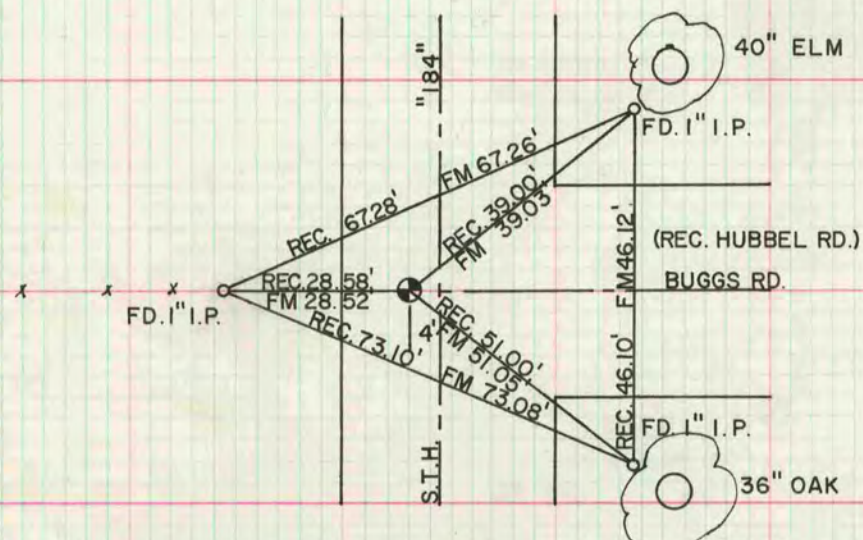

S 1/4 COR SEC 33

FD. 3/4" X 40" RE-BAR 0 H.H.'S REPLACED W/ALUM. MON.
U.P. FD. 1" I.P. BENT SLIGHTLY NW.

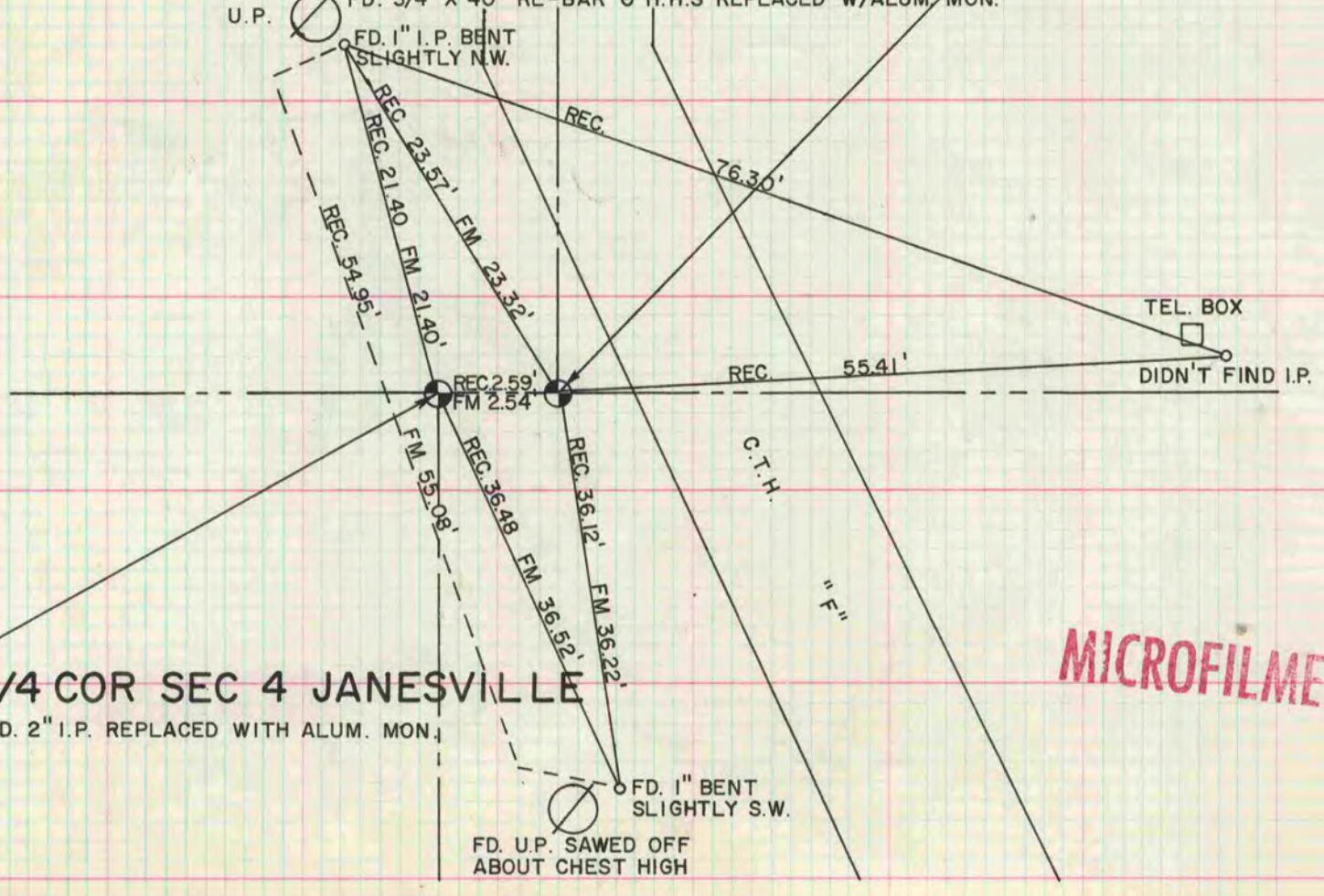

N 1/4 COR SEC 4 JANESVILLE

FD. 2" I.P. REPLACED WITH ALUM. MON.

FD. 1" BENT SLIGHTLY S.W.
FD. U.P. SAWED OFF ABOUT CHEST HIGH

MICROFILMED