

PLAT AND RECORD

Of a Survey on Section 31, 19, 20 T 4 R 12 E. of the 4 P. M. in FULTON Township
Rock County, Wisconsin, made OCTOBER the 5

I hereby certify that the following is a correct record of said survey as made by me

COUNTY BUILDING
CITY OF JANESVILLE

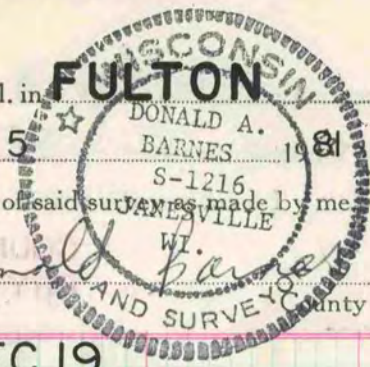

W 1/4 COR SEC 19

FD CAST IRON MON AT S.W. EDGE OF INTERSECTION— IN PAVEMENT

NW COR SEC 31

FD PK NAIL AT 2' DEEP FD L.S. 14"x10"x6" 0 4 HH's
REPLACED w/ ALUM MON

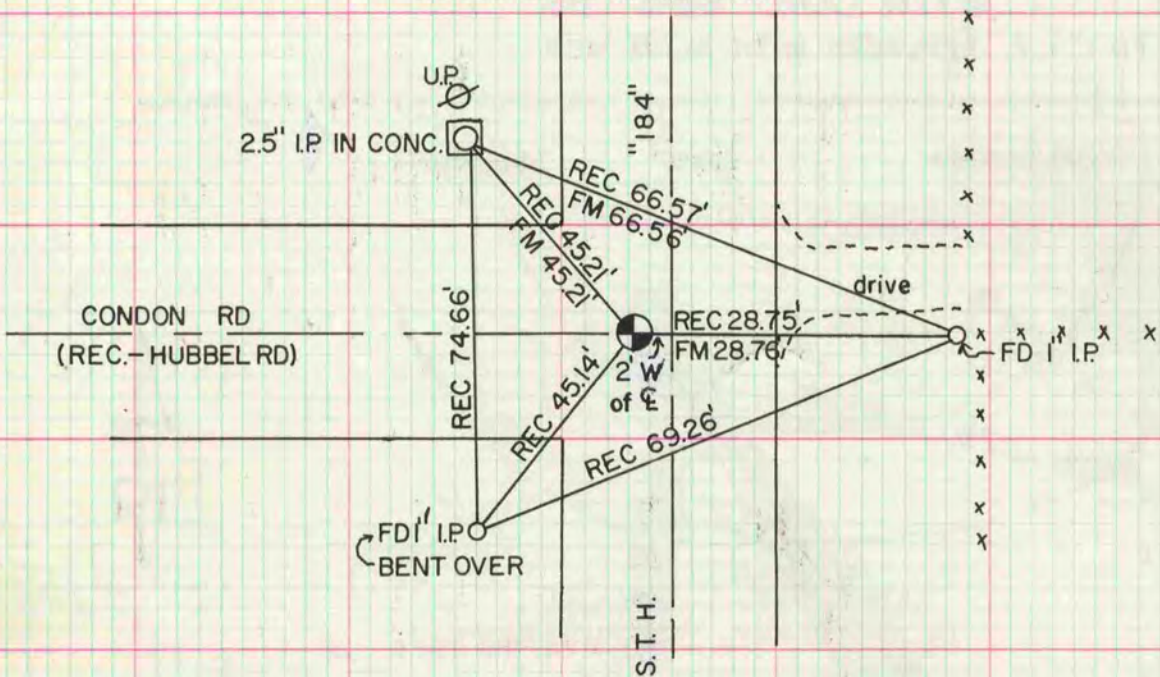

NE COR SEC 20

FD 1" I.P. — REPLACED WITH ALUM MON

MICROFILMED

