

PLAT AND RECORD

Of a Survey on Section 27, 21 T 2 R 14 E. of the 4 P. M. in BRADFORD Township

Rock County, Wisconsin, made OCTOBER 14

I hereby certify that the following is a correct record of said survey as made

COUNTY BUILDING
CITY OF JANESVILLE

Donald Barnes



N 1/4 COR SEC 27

FD CONC MON WITH BRASS CAP 0.3'

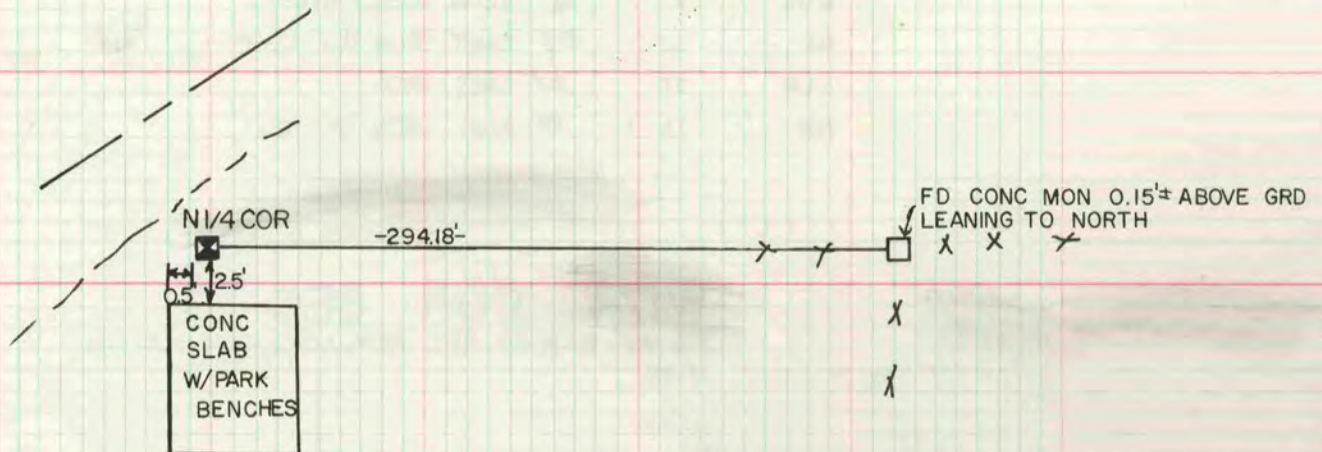

W 1/4 COR SEC 21

DUG & FD NOTHING. SET C.I. MON, ON LINE WITH E 1/4 COR SEC 21 & THE FD H.H., AT PRORATED DISTANCE.

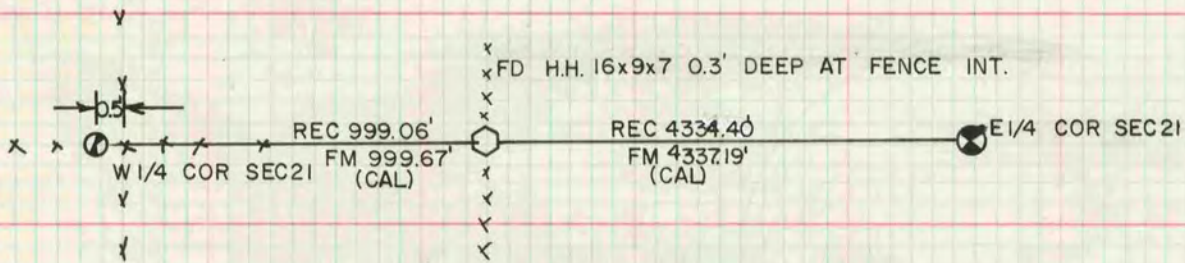

S 1/4 COR SEC 21

DUG & FD 1.2' DEEP 8x15x16 LIMESTONE & REMAINS OF STAKE ON SOUTH SIDE. REPLACED STAKE WITH ALUM MON. SET 1"x24" I.P. HORIZONTAL ON NORTH SIDE OF STONE.

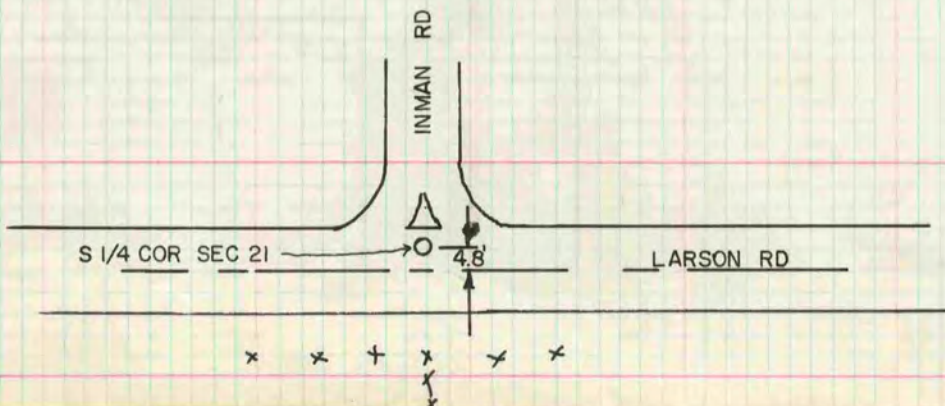

MICROFILMED