

PLAT AND RECORD

Of a Survey on Section 18, 23, 3, 14 E. of the 4 P. 14 JOHNSTOWN Township

Rock County, Wisconsin, made NOV the 19 81

I hereby certify that the following is a correct record of said survey as made by me.

COUNTY BUILDING CITY OF JANESVILLE

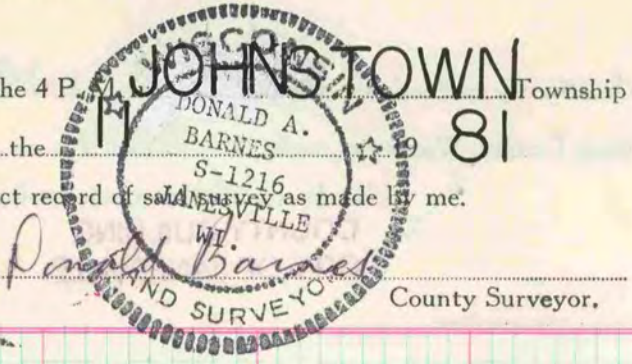

NW COR SEC 26

FOUND IRON-BAR (AXEL) REPLACED WITH POLYSTYRENE MON & SET CARSONITE POST

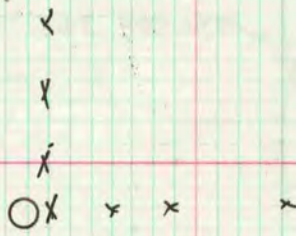

W 1/4 COR SEC 23

FOUND LARGE LIMESTONE POINT DOWN OLD FENCE E/W RIGHT NEXT TO IT N/S FENCE 2' EAST. REPLACED WITH POLYSTYRENE MON & SET CARSONITE POST.

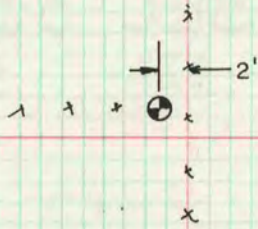

N 1/4 COR SEC 18

FOUND 1" IP REPLACED WITH POLYSTYRENE MON SET CARSONITE POST

W 1/4 COR SEC 1

FD ALUM MON

E 1/4 COR SEC 4

MOVED PILE OF LIMESTONES FROM AROUND FENCE INT. VOL I-209 CALLED FOR W.O. BY LARGE POINTED H.H. ON N. FLAT H.H. ON E. & SMALL OVAL H.H.'s ON S. & W. ABOUT 2' DEEP FD LARGE H.H. POINTED 24" X 12" X 12" ON N. SIDE FLAT H.H. ON E. SIDE & SEVERAL SMALL OVAL H.H.'s - S. & W. FD SOME PIECES OF OLD ROTTED WOOD

SET ALUM MON S. OF WHERE POINTED H.H. WAS & W. OF WHERE FLAT H.H. WAS. SET CARSONITE POST.

MICROFILMED