

PLAT AND RECORD

243

VOL. 6

Of a Survey on Section 12, 35 T 3N. R 12 E. of the 4 P. M. in JANESVILLE Township
Rock County, Wisconsin, made Feb 18 the

I hereby certify that the following is a correct record of said survey as made by me

COUNTY BUILDING
CITY OF JANESVILLE



E. 1/4 CORNER - SECTION 12

Found R.R. Spike 3.0' deep and laying horizontally. Set Polystyrene Monument at corner. Reference: Volume 4, Page 472.

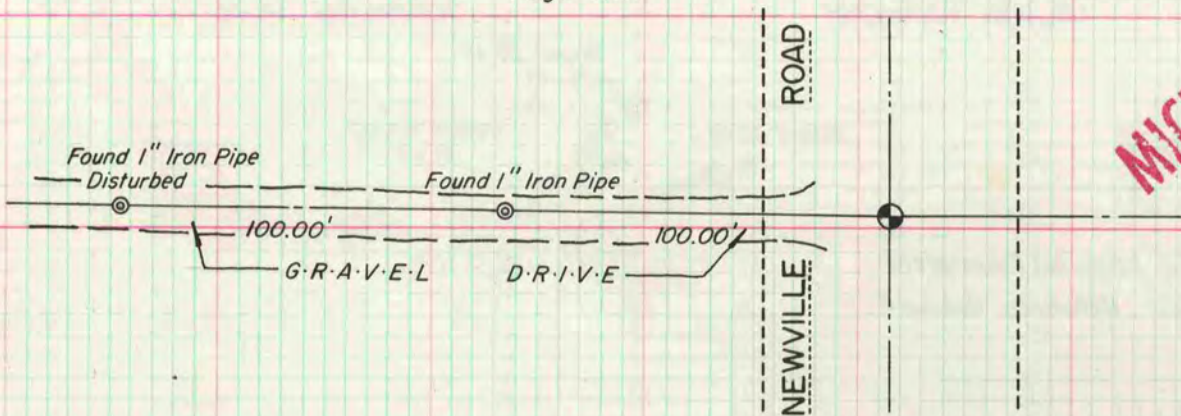

MICROFILMED

S.W. CORNER - SECTION 35

Referenced corner in order to re-set monument after construction of the Crosby-Williard Avenue Bridge has been completed. Reference: Volume 4, Page 126

