

PLAT AND RECORD

Of a Survey on Section 27, 28 T 4 R 11 E. of the 4 P. M. Township
Rock County, Wisconsin; made MAY the 11 1982

I hereby certify that the following is a correct record of said survey as made by me.

COUNTY BUILDING
CITY OF JANESVILLE

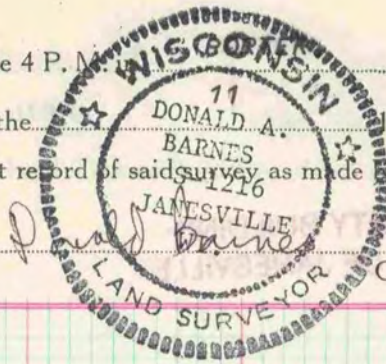

County Surveyor.

S. 1/4 CORNER-SECTION 28

DUG & FOUND 2' DEEP WOOD 1/2" IN DIAMETER & ABOUT 3" LONG. IT WAS AT SINGLE PROPORTIONATE DISTANCE AS RUGER CALLED FOR IN SURVEY. SET POLYSTRENE MONUMENT.



MICROFILMED

S. 1/4 CORNER-SECTION 27

AREA WAS ERODED. DUG SMALL HOLE & FOUND NOTHING. DECLARED CORNER LOST. SET POLYSTRENE MONUMENT AT SINGLE PROPORTIONATE DISTANCE. THIS IS ON LINE WITH THE FENCE TO THE NORTH & THE E/W FENCE.

