

PLAT AND RECORD

Of a Survey on Section 22 3 12 JANESVILLE Township
36 T 1 R 14 E. of the 4 P. M. in CLINTON
Rock County, Wisconsin, made FEBRUARY the 28

I hereby certify that the following is a correct record of said survey

COUNTY BUILDING 1
CITY OF JANESVILLE

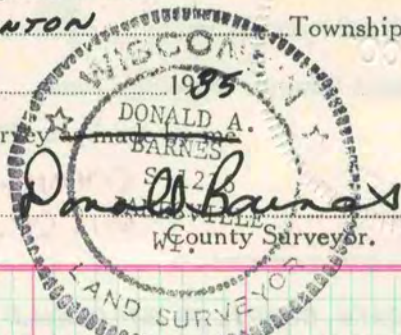

THE FOLLOWING ROAD RECORD INFORMATION IS FROM A BOOK THAT IS IN THE COUNTY CLERK'S VAULT. THE RECORDS ARE FROM 1840-1880. SOME OR ALL OF THE ROADS MAY NOT BE IN USE. THE BEARINGS AND DISTANCES OF THE CENTER LINE ARE RECORDED AS SURVEYED.

PAGE	SECTION	CORNER	ROAD	DESCRIPTION
<u>JANESVILLE TWP</u>				
91	22	NW	RD	2.69 ch ↙ . NW COR SEC 22

PAGE	SECTION	DESCRIPTION
<u>CLINTON TWP</u>		
67-68	36	"THE CENTER OF THE ROAD STRIKES THE EAST LINE OF ROCK COUNTY 50 LINKS NORTH FROM THE STATE LINE & CONTINUES WEST PARALL TO THE STATE LINE UNTIL IT STRIKES THE EAST LINE OF SECTION 36 T IN R I Z E" WHEELER SURVEYOR 1839

MICROFILMED