

# Property Division Map

City  
of  
Milton

T. 4 N. - R. 13 E.  
Section 35 SE

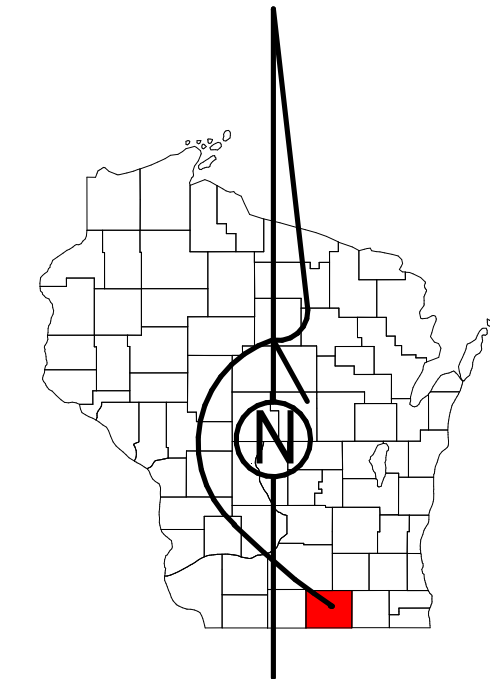

STATE OF WISCONSIN  
COUNTY OF ROCK

PREPARED BY

REAL PROPERTY DESCRIPTION  
DEPARTMENT

USING

ROCK COUNTY  
GEOGRAPHIC INFORMATION SYSTEM

DUPLICATION OF THIS MAP PROHIBITED  
WITHOUT THE WRITTEN CONSENT OF THE  
REAL PROPERTY DESCRIPTION DEPARTMENT.

THIS MAP WAS PREPARED PURSUANT  
TO SECTION 70.09 WIS. STATS.  
USING PUBLIC RECORDS. IT IS NOT INTENDED  
TO BE A SUBSTITUTE FOR AN  
ACTUAL FIELD SURVEY  
AND IS ADVISORY ONLY.

DISTANCES SHOWN ON THIS  
MAP WERE PRODUCED BY  
THE GIS SYSTEM AND ARE  
FOR REFERENCE ONLY.  
SEE DOCUMENT OF RECORD  
FOR ACTUAL DISTANCE.

0 25 50 100 150 200  
Feet

- |  |              |  |              |
|--|--------------|--|--------------|
|  | Gap          |  | dam          |
|  | Overlap      |  | easement     |
|  | CSM          |  | hydro        |
|  | CSMHYDRO     |  | lots         |
|  | CSMLOT       |  | parcels      |
|  | CSMLOT HYDRO |  | parcelshydro |
|  | MFL          |  | roadrw       |

See Pages

January 1, 2023

35 SE

35 NE

N CHICAGO ST

V-23-1467  
UNITED ETHANOL LLC  
50.94 A

V-23-1466.3  
CITY OF MILTON  
23.55 A

CSM 41-125

PUT.

V-23-1468.1  
BELARDI FAMILY INVESTMENTS LLC  
13.23 A

Town of Milton

415 96

Town of Milton

