

12 SENW

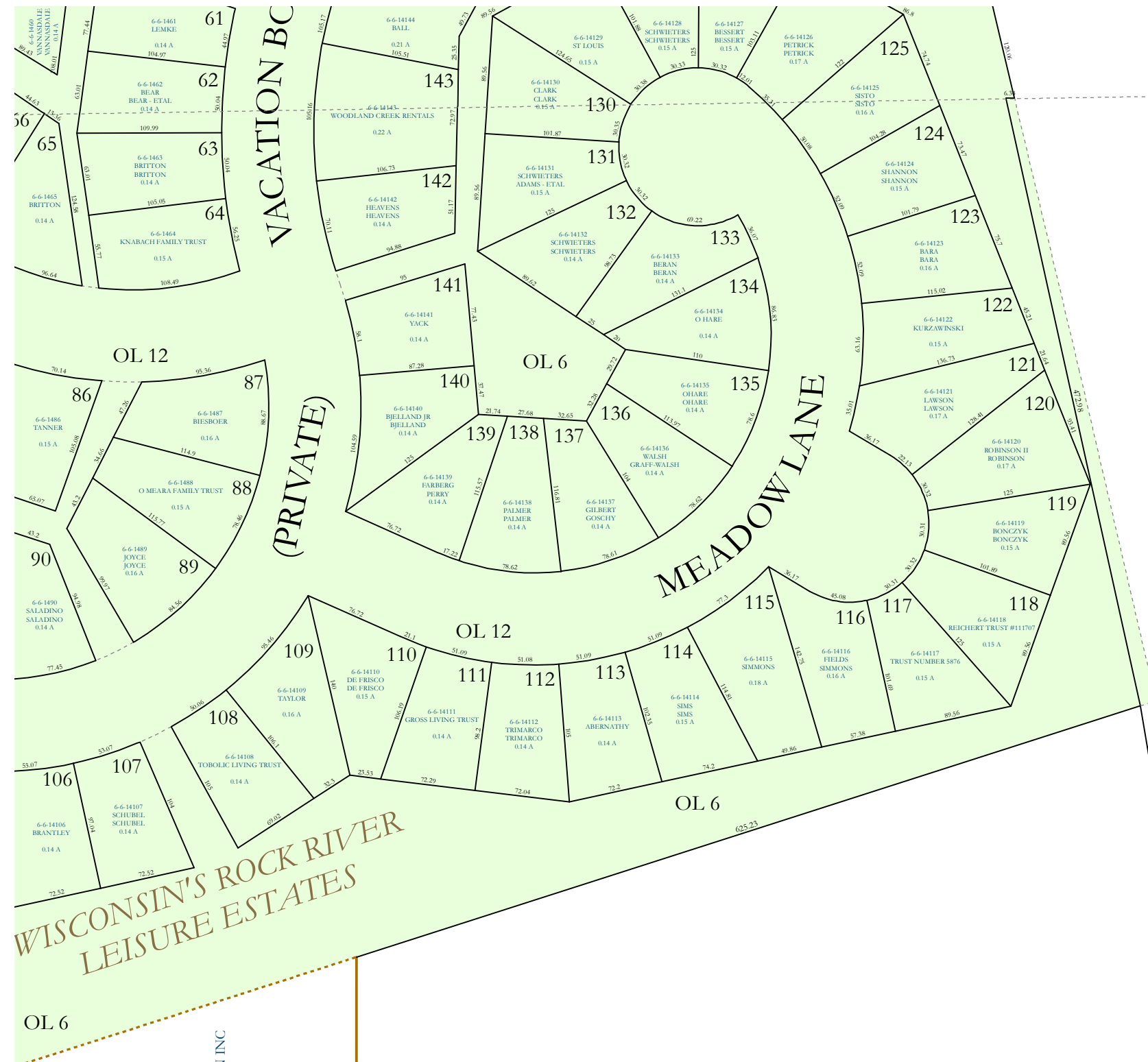

12 N1/4SW

PT GL 4

6-6-112 SHARON DEEGAN 18.22 A

WINDHELLA & NANCY L HETZ REVOCABLE LIVING TRUST

1

6-6-112.11 BACKYARD PROPERTIES OF ROCK COUNTY LLC 36.88 A

WISCONSIN'S ROCK RIVER LEISURE ESTATES HOME OWNERS ASSOCIATION INC 100.96 A

Property Division Map

Town of Fulton

T. 4 N. - R. 12 E.

Section 12 NESW

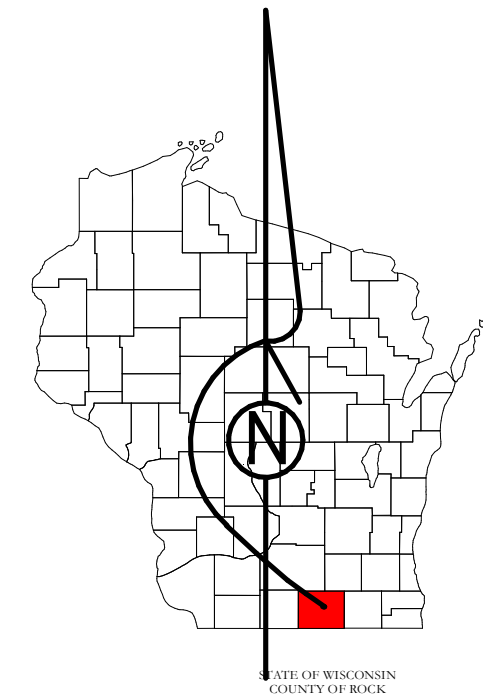

PREPARED BY
REAL PROPERTY DESCRIPTION DEPARTMENT
 USING
ROCK COUNTY GEOGRAPHIC INFORMATION SYSTEM

DUPPLICATION OF THIS MAP PROHIBITED WITHOUT THE WRITTEN CONSENT OF THE REAL PROPERTY DESCRIPTION DEPARTMENT.

THIS MAP WAS PREPARED PURSUANT TO SECTION 70.09 WIS. STAT. USING PUBLIC RECORDS. IT IS NOT INTENDED TO BE A SUBSTITUTE FOR AN ACTUAL FIELD SURVEY AND IS ADVISORY ONLY.

DISTANCES SHOWN ON THIS MAP WERE PRODUCED BY THE GIS SYSTEM AND ARE FOR REFERENCE ONLY. SEE DOCUMENT OF RECORD FOR ACTUAL DISTANCE.

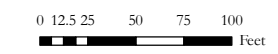

- Gap
- Overlap
- CSM
- CSMHYDRO
- CSMLOT
- CSMLOTHYDRO
- MFL
- dam
- easement
- hydro
- lots
- parcels
- parcelshydro
- roadrw

See Pages

January 1, 2023

12 NESW